

VOICE RECOGNITION TIPS

BLUETOOTH®

Command **Example**
Dial <Phone #> — “Dial
7-1-4-0-0-0-8-8-8-8”

Call <Name> — “Call John Smith”

Improving how you store your contacts can optimize your Bluetooth® Voice Recognition performance:

- Use full names instead of short or single-syllable names (“John or Dad”)
- Avoid using special characters/emojis or abbreviations (“Dr.”) when saving contacts

NAVIGATION

Command **Example**
Find Address — “1-2-3-4-5 1st Street,
<House #, Street, Fountain Valley”
<City, State>

Find <POI Name> — “Find McDonald’s”

Located on Rearview Mirror

LOCAL SEARCH



Command **Example**
Find <POI Name> — “Find Lowe’s® near me”
<POI Name> — “Starbucks®”

DEMONSTRATE AUTOMATIC CLIMATE CONTROL - page 17

DEMONSTRATE HOW TO OPERATE WINDSHIELD WIPER AND WASHER – page 12

HOW TO DEFROST

- 1 Press the front defrost button.
- 2 Set to warmest temperature setting.
- 3 Set to highest fan speed.

TIRE PRESSURE MONITORING SYSTEM (TPMS)- page 42

Low tire pressure indicator /
TPMS malfunction indicator

NOTE: Tire pressure may vary in colder temperatures causing the low tire pressure indicator to illuminate. Inflate tires according to the Tire Pressure Label located on the driver’s side door pillar.

INTRODUCTION AND LOCATION OF THE SERVICE DEPARTMENT

SET FIRST SERVICE VALET APPOINTMENT

REVIEW FACTORY RECOMMENDED MAINTENANCE SCHEDULE

WAS THE CONDITION OF YOUR VEHICLE (AT DELIVERY) TO YOUR SATISFACTION?

GENESIS CONNECTED SERVICES

- Assist with creating a Genesis Owners account
- Assist with Genesis Connected Services enrollment
- Show Genesis Connected Services Users Manual
- Encourage customer to download the Genesis Intelligent Assistant App

Sales Consultant _____ Date _____ Sales Manager _____ Date _____

New Owner _____ Date _____

Email _____ @ _____

MAINTENANCE

Scheduled Maintenance (Normal Usage)		2.5T		3.5T
Engine Oil And Filter	Replace	8,000 or 12 mos.	Replace	8,000 or 12 mos.
Fuel Additives	Add	7,500 or 12 mos.	Add	6,000 or 12 mos.
Tire Rotation	Perform	7,500 or 12 mos.	Perform	6,000 or 12 mos.
Vacuum Hose				
Air Conditioning Refrigerant				
Brake Hoses & Lines				
Drive Shafts & Boots				
Exhaust Pipe & Muffler				
Front Brake Disc/Pads, Calipers	Inspect	7,500 or 12 mos.	Inspect	6,000 or 12 mos.
Rear Brake Disc/Pads				
Steering Gear Box, Linkage & Boots/ Lower Arm Ball Joint, Upper Arm Ball Joint				
Suspension Mounting Bolts				
Propeller Shaft				
Air Cleaner Filer	Inspect	7,500 or 6 mos.	Inspect	7,500 or 6 mos.
	Replace	30,000 or 24 mos.	Replace	30,000 or 24 mos.
Climate Control Air Filter (For Evaporator And Blower Unit)	Replace	Every 12 mos.	Replace	Every 12 mos.
Fuel Tank Air Filter				
Fuel Filler Cap, Fuel tank	Inspect	16,000 or 24 mos.	Inspect	16,000 or 24 mos.
Brake Fluid				
Parking Brake				
Fuel Lines, Fuel Hoses And Connections	Inspect	16,000 or 24 mos.	Inspect	16,000 or 24 mos.
Front(AWD)/Rear Differential Oil	Inspect	30,000 or 48 mos.	Inspect	24,000 or 48 mos.
Drive Belt	Inspect	First 48,000 or 72 mos. Subsequent, every 8,000 or 12 mos.	Inspect	First 48,000 or 72 mos. Subsequent, every 8,000 or 12 mos.
Spark Plugs (Iridium Coated)	Replace	48,000	Replace	48,000
Coolant	Replace	First 120,000 or 120 mos. Subsequent, every 30,000 or 24 mos.	Replace	First 120,000 or 120 mos. Subsequent, every 30,000 or 24 mos.
Automatic Transmission Fluid	No checks or services required for Normal Usage driving.			

*Check the engine oil regularly between recommended oil change. Genesis Branded Vehicle recommend Full synthetic Oil.

*The fuel filter is considered to be maintenance free but periodic inspection is recommended for this maintenance schedule depends on fuel quality. If there are some important safety matters like fuel flow restriction, surging, loss of power, hard starting problem etc, replace the fuel filter immediately regardless of maintenance schedule and consult an authorized GENESIS or HYUNDAI dealer for details.

*See Owner’s Manual for details.

Looking For more detailed information? This Quick Reference Guide does not replace your vehicle’s Owner’s Manual. If you require additional information or are unsure of a specific issue, we recommend that you always refer to the vehicle’s Owner’s Manual or contact your authorized retailer of Genesis Branded Products. The information contained in this Quick Reference Guide is correct at the time of printing; however, specifications and equipment can change without notice. No warranty or guarantee is being extended in this Quick Reference Guide, and Genesis Brand reserves the right to change product specifications and equipment at any time without incurring obligations. Some vehicles are shown with optional equipment.

NP150-0R2022
(Rev 12/16/21)
Printing 12/19/21

GENESIS GV70

QUICK REFERENCE GUIDE



GENESIS

GENESIS BRANDED VEHICLE OWNER PRIVACY POLICY

Your Genesis Branded Vehicle may be equipped with technologies and services that use information collected, generated, recorded or stored by the vehicle. We have created a Vehicle Owner Privacy Policy to explain how these technologies and services collect, use, and share this information.

You may read our Vehicle Owner Privacy Policy at www.genesis.com/us/en/my-privacy-rights.html#owner. If you would like to receive a hard copy of our Vehicle Owner Privacy Policy, please contact Customer Care at:

Genesis Customer Care
Genesis Motor America/Phoenix
P.O. Box 83835
Phoenix, AZ 85071-3835
CustomerCare@genesismotorsusa.com

Genesis Customer Care Center representatives are available Monday through Friday, between the hours of 5:00 AM and 5:00 PM PST and Saturday between 6:30 AM and 3:00 PM PST (English). For Customer Care assistance in Spanish or Korean, representatives are available Monday through Friday between 6:30 AM and 3:00 PM PST.

Roadside Assistance: **1-844-340-9742**
SiriusXM® Radio: **1-800-967-2346**
Genesis Customer Care &
Connected Services: **1-844-340-9741**
www.MyGenesis.com



Electronic Stability Control (ESC)
Page 35



Instrument cluster
Page 13



Infotainment
Page 29

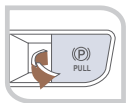
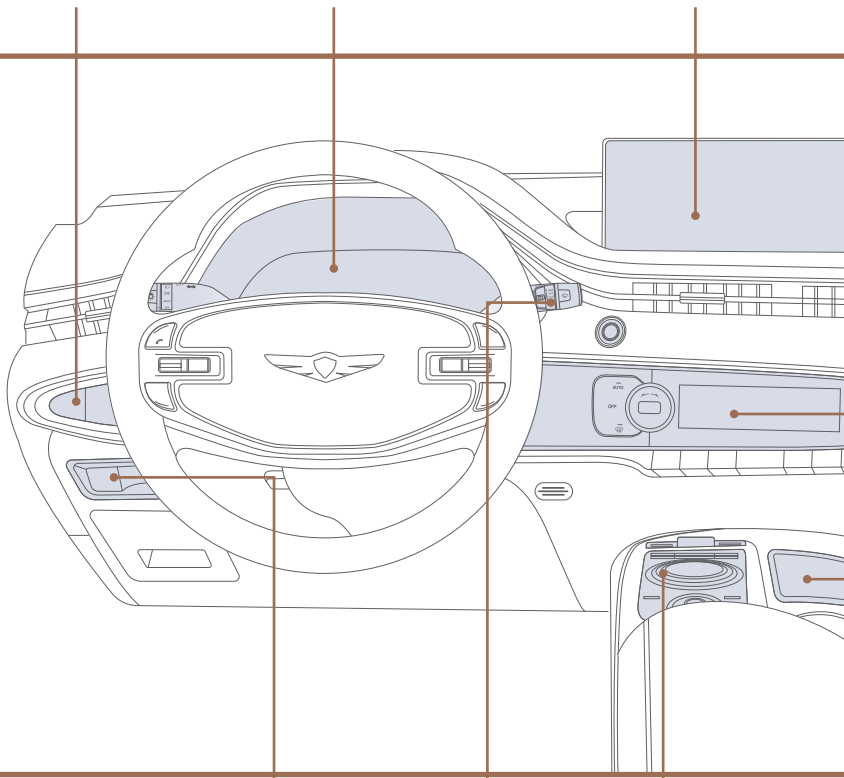

Electric Parking Brake (EPB)
Page 43

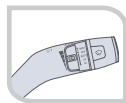

Wiper and washer
Page 12



Shift by wire gear selector
Page 34

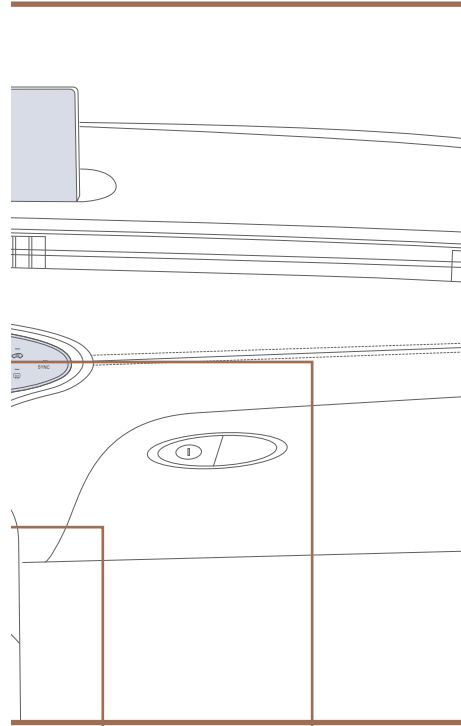

USB Ports
Page 30



Climate control system
Page 17

WARNING!

To reduce the risk of serious injury to yourself and others, read and understand the important SAFETY INFORMATION in your Owner's Manual.

FEATURES AND CONTROLS

Climate control system	17
Door lock	02
Driver's main controls	07
Fuel filler door	08
Headlights	11
Head-up display	16
Instrument cluster	13
Interior lights	10
LCD display mode control	15
LCD display view modes	15
Panoramic sunroof	09
Seat-Driver position memory system	04
Seat-Front seat adjustment	03
Seat-Headrest adjustment	04
Seat-Seat warmer & cooler	05
Smart key	01
Smart trunk	06
Trunk operation	06
Warnings and indicators	16
Wipers and washer	12

INFOTAINMENT

Android Auto™	23
Apple CarPlay™	25
Audio control	31
Bluetooth phone pairing	19
Genesis connected services	20
Homelink wireless garage control system	32
Navigation	29
Power outlet	30
Radio	31
USB ports	30
Wireless cellular phone charging system	31

DRIVING

Auto hold	43
Blind-Spot Collision-Avoidance Assist (BCA)	37
Digital key pairing	46
Driver Attention Warning (DAW)	37
Electric Parking Brake (EPB)	43
Electronic Stability Control (ESC)	35
Fingerprint Authentication System	45
Forward Collision-Avoidance Assist (FCA)	35
Forward/Reverse Parking Distance Warning (PDW)	41
Highway Driving Assist (HDA)	39
Idle Stop and Go (ISG)	44
Lane Flooding Assist (LFA)	39
Lane Keeping Assist (LKA)	36
Near Field Communication (NFC)	47
Oil change reminder	48
Rear view monitor	40
Remote Start Parking Assist (RSPA)	40
Shift by Wire (Electronic type shifter)	34
Smart Cruise Control (SCC)	38
Tire Pressure Monitoring System (TPMS)	42
Warning timing and volume	41

*Some vehicles may not be equipped with all the listed features.

Use this Quick Reference Guide to learn about the features that will enhance your enjoyment of your Vehicle. More detailed information about these features are available in your Owner's Manual.

SMART KEY

Type A

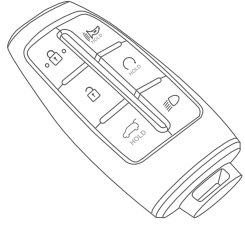

- Lock
- Unlock
- Trunk open
- Panic

Type B

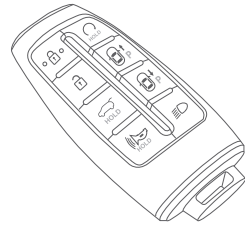

- Remote Start
- Remote Smart Parking Assist
- Lamp ON

Remote start using Smart Key (if equipped)

You can start the vehicle using the Remote Start button on the smart key.

To start the vehicle remotely:

1. Press the door lock button on the smart key within 32 feet (10m) from the vehicle.
2. Press the Remote Start button for more than 2 seconds within 4 seconds after pressing the door lock button.
3. The hazard warning lights will blink and the engine will start.
4. To turn off the remote start function, press the Remote Start button once.

Accessing mechanical key

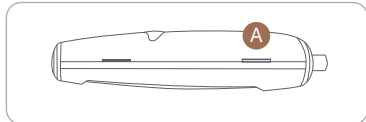

1. Place a soft cloth over the groove **A**, and pry open the smart key cover.

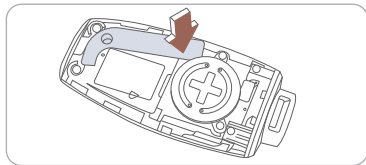

2. Press the mechanical key and remove it from the smart key FOB.

DOOR LOCK

Operating Door Locks from Outside the Vehicle

Mechanical Key

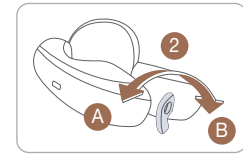
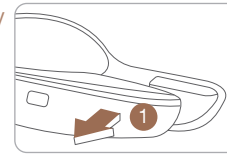

After pulling the door handle **1**, turn the key **2** toward the front of the vehicle to lock **A** or turn the key toward the rear of the vehicle to unlock **B**.

If you lock the driver's door with a mechanical key while the engine is running, turn the key **2** TWICE toward the front of the vehicle to lock **A**.

If you lock/unlock the driver's door with the mechanical key, only the driver's door will lock/unlock automatically, not others.

Once the doors are unlocked, they can be opened by pulling the door handle. When closing the door, push the door by hand. Make sure that doors are closed securely.

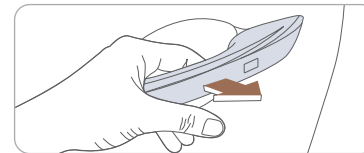

Driver's door Lock / Unlock

- **To Unlock** : Place your hand inside the door handle
- **To Lock** : Press the touch sensor on the outside of the handle to lock.

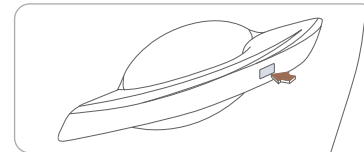

* CAUTION

- If you locked the door with the touch sensor on the door handle, the doors cannot be unlocked with the sensor within 3 seconds.
- If you unlocked the door with the touch sensor on the door handle, the doors cannot be locked with the sensor within 2 seconds.

NOTE: User selectable option: Please see section 5 from your Owner's Manual for more details.

FRONT SEAT ADJUSTMENT

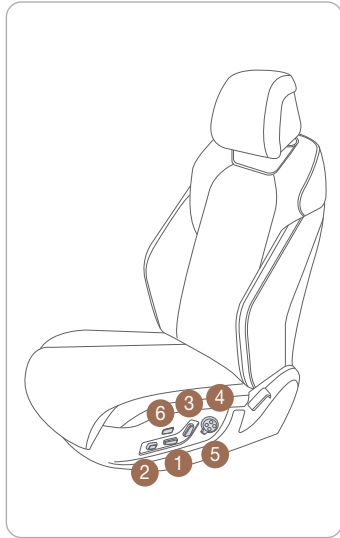

Forward and backward ①

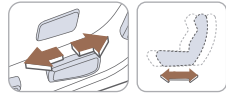

Seat cushion length (for driver's seat) ②

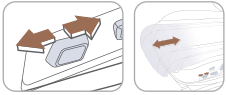

Seat cushion support (for driver's seat) ②



Seatback angle ③

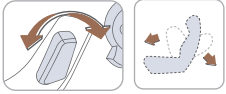

Seat cushion height ①

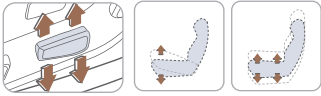

Lumbar support ④



Seat bolster adjustment (for driver's seat) ⑤

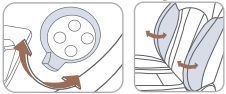

Ergo-Motion seat (if equipped) ⑥

Ergo-Motion seat automatically adjust the driver seat during long drives. After driving for an hour, the Smart Posture assist automatically adjusts the pelvis and back portion of the driver's seat. Setting can be activated/deactivated from the settings menu.

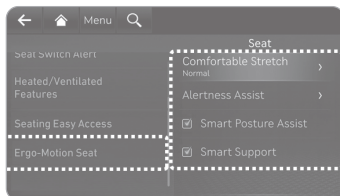

HEADREST ADJUSTMENT

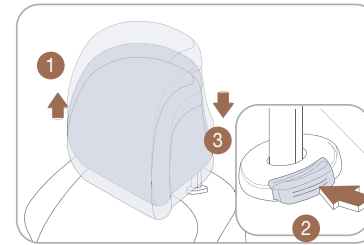

Adjusting the height up and down

To raise the head restraint:

1. Pull it up to the desired position ①.

To lower the head restraint:

1. Push and hold the release button on the head restraint support. ②
2. Lower the head restraint to the desired position ③.

DRIVER POSITION MEMORY SYSTEM (if equipped)

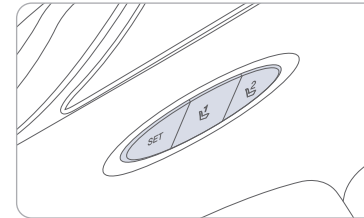

To Store Settings

1. Shift to P (Park) while the Engine Start/Stop button is in the ON position.
2. Adjust the driver's seat position, outer side view mirror position, steering wheel position.
3. Press the SET button. The system will beep once and notify you 'Press button to save settings' on the cluster LCD display.

NOTE: To reset the system, please refer to the Owner's Manual.

4. Press one of the memory buttons (1 or 2) within 4 seconds. The system will beep twice when the memory has been successfully stored.
5. 'Driver 1 (or 2) settings saved' will appear on the cluster LCD display. The message appears only for the driver's seat position memory setting.

NOTE: Transmission must be in P (Park).

To Recall

Press the desired memory button (1 or 2). The system will beep once.

SEAT WARMER



Each time you push the button, the setting is changed as follows:



Rear Seat Warmers

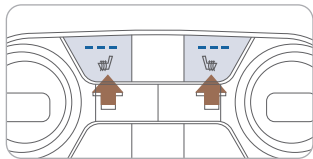

To turn off immediately, press and hold the button.

SEAT COOLER

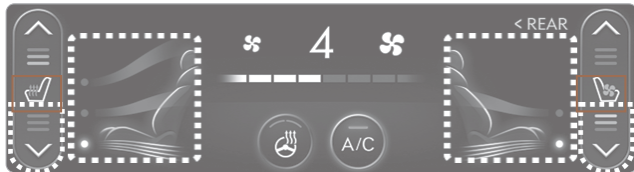

- Heat - Air Ventilation

Each time you push the button, the setting is changed as follows:



Rear Seat Cooler

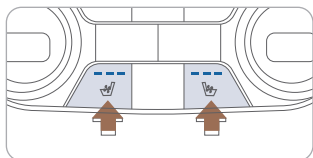

To turn off immediately, press and hold the button.

TRUNK OPERATION

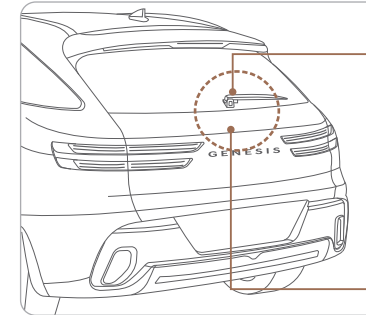

Power trunk open button

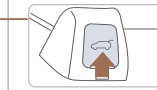

Press to open.
Smart key needs to be within the range.

Power trunk open button on the smart key

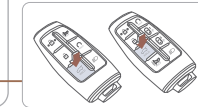

Press and hold.

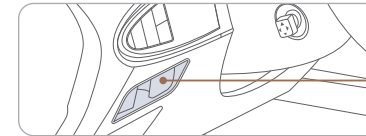

Power trunk main control button

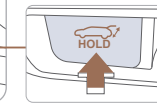

Press to open.
Press and hold to close.

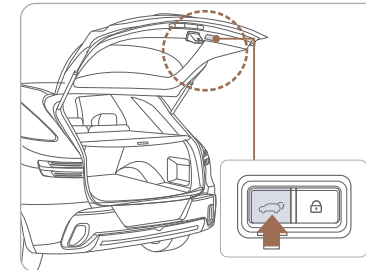

Closing the trunk

Lower the trunk lid and press down until it locks. To be sure the trunk lid is securely fastened, always check by trying to pull it up again.

NOTES: Trunk opening height adjustment is available in the Vehicle setup options. Please refer to your Owner's Manual for further information.

SMART TRUNK

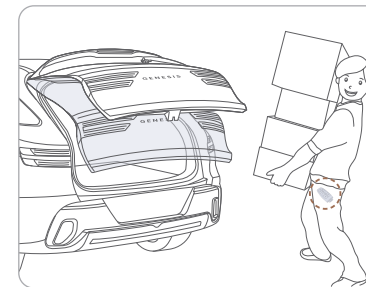

Smart Trunk

When smart key is within range for 3 seconds, the trunk will automatically open.

To enable Smart Trunk function:

Vehicle must be in P (Park) to adjust the settings located in the setup menu in the AVN system screen.

1. Select Setup > Vehicle > Door/Trunk
2. Check "Smart Trunk".

NOTE: Function is active after 15 seconds when all doors are closed and locked. The vehicle will also provide an audible and visual alarm while activating. Please refer to your Owner's Manual for further information.

DRIVER'S MAIN CONTROLS

Driver's door

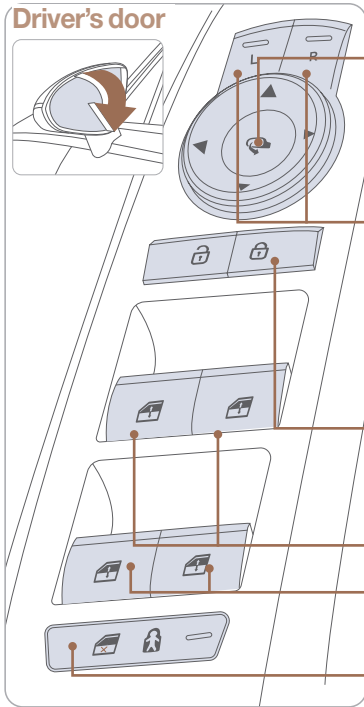

Outside Rearview Mirror

- Press switch to unfold/fold mirrors. Press the lock or unlock button on the smart key, and the mirrors will be folded or unfolded.
- Press the L or R button to adjust the mirror by using the directional switch. If L or R button is still selected, both mirrors will tilt downward when reversing. Deselect L or R will disable the auto tilt down feature.

Door Lock

- Locks/unlocks all doors.

Window Switches

- Front power window switches.
- Rear power window switches.

Electronic Child Lock (if equipped)

- When the electronic child lock button

FUEL FILLER DOOR

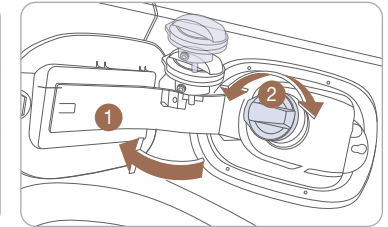
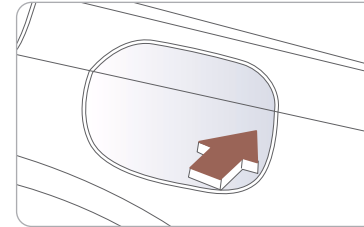

Opening the fuel filler door:

1. Turn the engine off.
2. Press the fuel filler door to open.
3. Pull the fuel filler door **1** outward to access the fuel tank cap.
4. To remove the fuel tank cap **2**, turn it counterclockwise.
5. Place the cap on the fuel filler door.

PANORAMIC SUNROOF

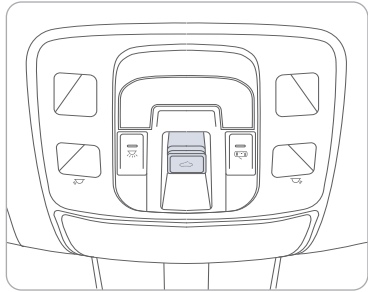

Sunshade



To open the sunshade, pull the sunroof control lever lightly backward to the first detent position. Push the sunroof control lever forward to close.

Sliding the sunroof

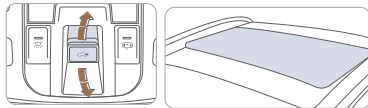

Pull the sunroof control lever backward past the first detent to slide open the sunroof control lever forward to the second detent position to close sunroof glass with the sunshade.

Tilting the sunroof

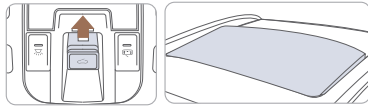

Push the sunroof control lever upward to tilt open the sunroof. Push again the sunroof control lever upward to tilt the sunroof glass closed.

INTERIOR LIGHTS

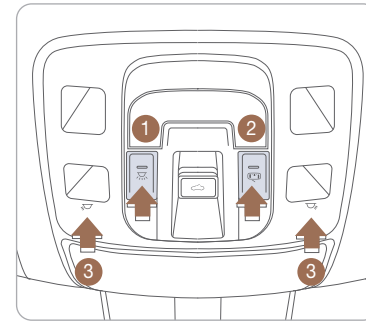

Room Lamp (Rear)

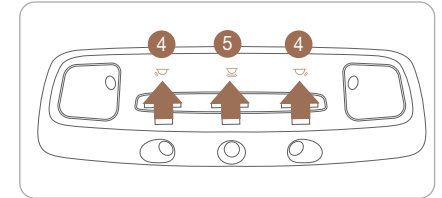

Master Switch (☀️) ①

Push the switch to turn front map lamp and rear room lamp on or off

When the Master Switch ① is pushed, the other Switches ②, ③, ④, ⑤ don't operate.

Door Mode Switch (🚪) ②

When the Door Mode Switch ② is pushed, map lamp ③ and rear room lamp ④, ⑤ turn on if any door is opened and will turn off after all doors are closed.

Map Lamp Touch Switch (☀️, ☀️) ③

Touch the symbol to turn on and off for each side of map lamp.

Rear Map Lamp Touch Switch (☀️, ☀️) ④

Touch the symbol to turn on and off for each side of rear map lamp.

Rear Mood Lamp Touch Switch (☀️) ⑤

Touch the symbol to turn on and off rear mood lamp.

HEADLIGHTS

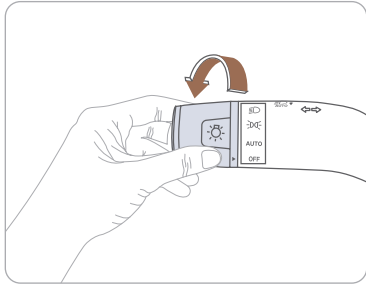

- ▶ | HEADLIGHTS
- ▶ | PARKING LIGHTS
- ▶ | **AUTO** AUTO HEADLIGHTS
- ▶ | **OFF** ALL LIGHTS OFF

Headlight delay

Headlights may stay on for 15 seconds after exiting and locking up the vehicle. Press the remote lock button twice to turn the headlights off. Please refer to your Owner's Manual for further information.

Turn signals **A** and lane change **B** signals

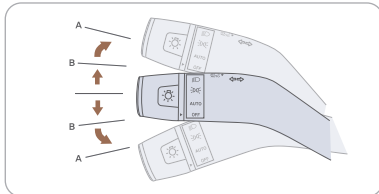

Flashing headlights

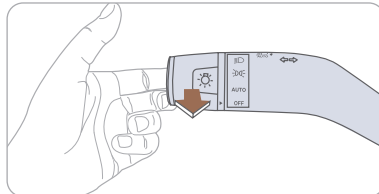

High beam

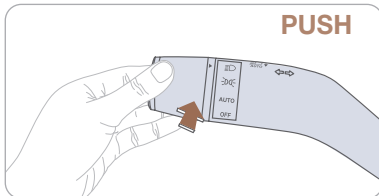

High Beam Assist

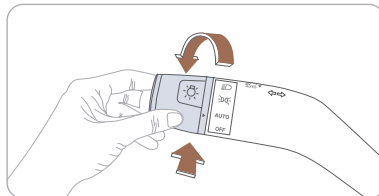

NOTE: To turn off the high beam, pull the lever towards you.

Function operation

1. Select auto position on stalk.
2. Push lever forward to engage Auto High beam.
3. Push lever forward again to disengage.

WIPERS AND WASHER

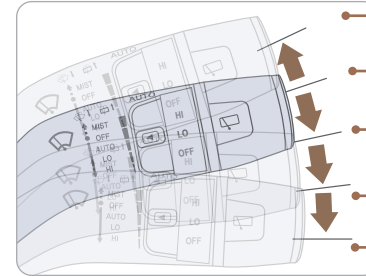

- **MIST** - Single wipe
- **OFF**
- **AUTO** - Auto control wipe
- **LO** - Low wiper speed
- **HI** - High wiper speed

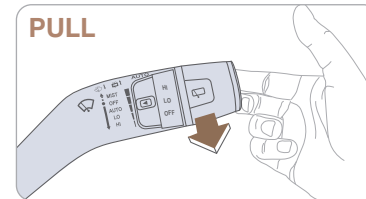

Front Windshield Washer

Pull the lever gently toward you to spray washer fluid onto the windshield and to run the wipers 1-3 cycles. Push the lever away from you to spray rear washer fluid and to run the rear wipers 1-3 cycles.

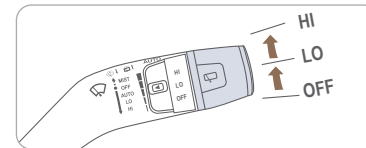

Rear Windshield Washer

The rear window wiper and washer switch is located at the end of the wiper and washer switch lever. Push the lever away from you to spray rear washer fluid and to run the rear wipers 1~3 cycles.

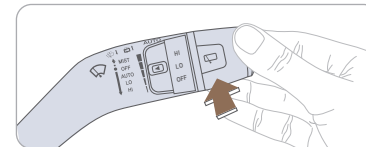

Wiper Blade Removal

1. Within 20 seconds of turning off the engine, lift and hold the wiper lever up to MIST position for about 2 second until the wipers move to the top wipe position
2. At this position, you are able to lift the wipers off the windshield.
3. Gently put wipers back down onto windshield
4. Turn the wipers to any ON position to return to resting position

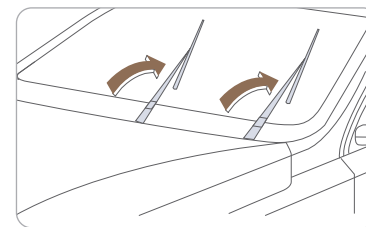

NOTE: To prevent damage to the hood and wiper arms, the wiper arms should only be lifted when in the top wiping position.

INSTRUMENT CLUSTER

Type A with 8" LCD Display



Type B with 12.3" LCD Display with 3D feature



- 1 Tachometer
- 2 Speedometer
- 3 Engine coolant temperature gauge

- 4 Fuel gauge
- 5 Warning and indicator lights
- 6 LCD display

LCD DISPLAY VIEW MODES

View	Symbol	Explanation
Driving Assist		Driving Assist view displays the status of the vehicle's Driver Assistance systems.
Turn By Turn (TBT)		Turn By Turn view displays the state of the navigation.
Utility		Utility view displays driving information such as the trip distance, fuel economy driver attention level and TPMS display.

LCD DISPLAY MODE CONTROL

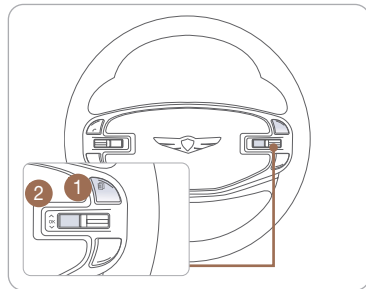

- 1 : VIEW button for changing modes
- 2 : SCROLL UP, DOWN for changing items
- OK (Press) : SELECT/RESET button for setting or resetting the selected item

WARNINGS AND INDICATORS

Air bag warning light	Seat belt warning	Parking brake & Brake fluid warning light
Anti-lock Brake System (ABS) warning light	Electronic Brake Force Distribution (EBD) system warning light	
Electric Power Steering (EPS) warning light	Malfunction Indicator Lamp (MIL)	Charging system warning light
Engine coolant temperature warning light	Engine oil pressure warning light	Low fuel level warning light
ECO indicator	Door open warning light	Trunk open warning light
AWD warning light	Electric Parking Brake (EPB) warning light	Forward Safety warning light
Master warning light	Electronic Stability Control (ESC) indicator	Electronic Stability Control (ESC) OFF indicator
Immobilizer indicator	Turn signal indicator	Low beam indicator
High beam indicator	Light ON indicator	High Beam Assist
Cruise indicator	Adaptive Front Lighting System	AUTO HOLD indicator
SPORT mode indicator	Lane Safety indicator	LED Headlight warning indicator
AUTO STOP indicator light	Low Tire Pressure Warning Indicator/TPMS Malfunction Lamp	

HEAD-UP DISPLAY

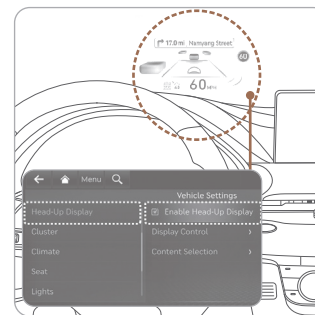

The Head-Up display is a transparent display which projects an image of selected information of the instrument cluster and navigation onto the windshield glass. To activate the head up display, select Head-Up Display in the Vehicle Settings menu on the infotainment screen. Adjust Head-Up Display height until in view.

NOTE: If you wear polarizing-filter sunglasses, it's difficult to read the Head Up Display information.

CLIMATE CONTROL SYSTEM

Front seat control

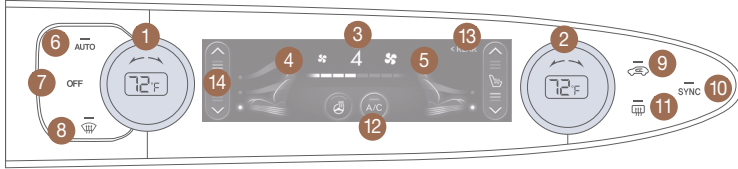

- | | |
|-----------------------------------|--|
| 1 Driver's temperature control | 8 Front windshield defroster |
| 2 Passenger's temperature control | 9 Air intake control |
| 3 Fan speed control | 10 SYNC |
| 4 Driver's mode selection | 11 Rear window defroster |
| 5 Passenger's mode selection | 12 A/C (air conditioning) |
| 6 AUTO (automatic control) | 13 Rear temperature control |
| 7 OFF (system off) | 14 Heated/Ventilated seats (if equipped) |

Rear seat control (if equipped)

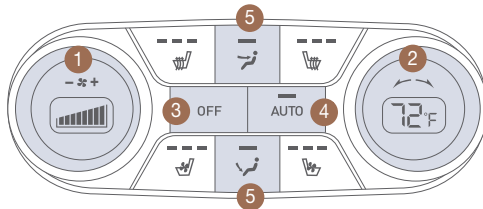

- | | |
|-----------------------|----------------------------|
| 1 Fan speed control | 4 AUTO (automatic control) |
| 2 Temperature control | 5 Mode selection |
| 3 OFF (system off) | |

SMART VENT

If cabin humidity increase while Climate Control is off, fresh air will be circulated into the cabin.

Please refer to the Owner's Manual for further details.

AUTOMATIC HEATING / AIR CONDITIONING

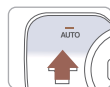

Automatically controls the modes, fan speeds, air intake and air-conditioning functions.

DEFOGGING/DEFROSTING

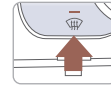

1. Press the front defrost button.

NOTE: Outside (fresh) air position will be selected when front defrost button is selected.

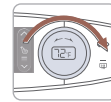

2. Select warmest temperature.



3. Set the fan speed to the highest speed setting.

NOTE: To reduce window fogging and improve visibility, keep the interior surface of the windshield clean by wiping it with a clean cloth and glass cleaner. In addition, position the air intake control to circulate fresh air whenever possible while operating the vehicle.

SYSTEM OFF

Pressing the OFF button will place the system in below settings.

- Front blower will turn off.
- Outside (fresh) air position will be selected.
- Vented air will be at last set temperature.

MODE SELECTION

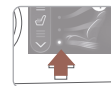

Touch the arrows on the climate control information screen to select air flow direction.

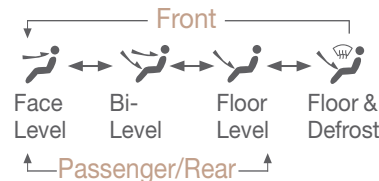

NOTE: Use a microfiber towel to prevent scratches on the climate controls while removing fingerprints, dust, or stains. Immediately wipe off any interior cleaning products to prevent damage to the climate controls.

AIR INTAKE CONTROL



Recirculation mode

When Recirculation mode is selected, air from the passenger compartment will be recirculated through the system and heated or cooled according to the function selected.



Fresh mode

When Fresh mode is selected, air enters the vehicle from outside and is heated or cooled according to the function selected.

BLUETOOTH PHONE PAIRING

Pairing a new device

NOTE: Vehicle must be in (P) Park to complete pairing process.

1. Press the  button in the steering wheel remote control.

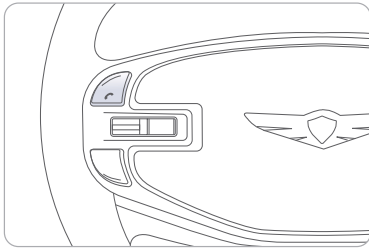

2. Search for the device name as displayed on your mobile phone and pair.
3. Confirm the 6-digit passkey displayed on the audio screen and the Bluetooth device identical.
4. Press OK in your Bluetooth device.
5. Pairing is complete.

GENESIS CONNECTED SERVICES

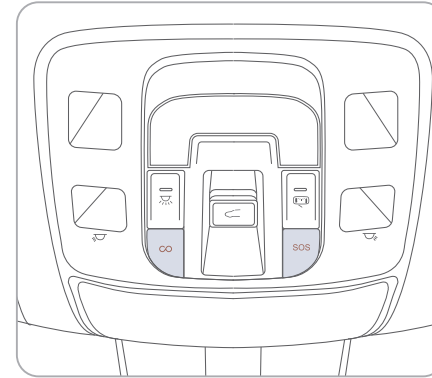

Genesis Connected Services subscription is required. To enroll, please visit your dealership or MyGenesisUSA.com.

Press the  button for access to the voice-response menu of services.

- You can say:

Roadside Assistance

Service Link

Account Assistance

Press the  button for SOS Emergency Assistance.

Visit MyGenesisUSA.com for more information or refer to your Genesis Connected Services User's Manual for detailed information on system operation.

For immediate assistance with subscription services, please call 1-844-340-9741.

Genesis Intelligent Assistant App



You can download the Genesis Intelligent Assistant App to your compatible smart phone from the following sites:

- iPhone® — Apple® App Store
- Android™ — Google Play™

Remote Start

Remote Start enables you to remotely start your vehicle virtually from anywhere. For vehicles equipped with full-automatic temperature control, you can also enable climate control remotely and turn on the front window defroster, ensuring a warm or cool car is ready to go when you are.

-  To use this feature, you must have a Genesis Connected Services Personal Identification Number (PIN). To create or change your PIN, log in to MyGenesisUSA.com.

Remember:

- Remote Start will automatically shut off after 10 minutes or after selected engine timer runs out in navigation vehicles.
- While this feature is active, the parking lights will blink until the vehicle is turned off or when vehicle is in operation.
- To continue to operate the vehicle, the proximity key must be inside the vehicle with the driver, prior to pressing the brake and being able to move the gearshift from the P (Park) position.

NOTE: Remote Start is only available for push button start equipped vehicles with an Automatic Transmission or a Dual Clutch Transmission (DCT).

Preconditions:

- Ignition is OFF
- Alarm is armed (i.e., vehicle locked by key fob or Remote Door Lock)
- Gearshift level is in the P (Park) position
- Brake pedal is not depressed
- Engine hood is securely closed
- All the doors are closed and locked
- The tailgate or trunk lid is closed
- The security / panic system is not activated
- The battery power is not low
- Vehicle is located in an open area
- It has been less than 4 days since last vehicle ignition off
- Vehicle located in area with good cell reception

Remote Start will terminate:

- After 10 minutes or after selected engine timer runs out in navigation vehicles
- Brake is pressed without the proximity key inside the vehicle
- Alarm is triggered without the proximity key inside the vehicle
- Door / trunk is opened from inside the vehicle

Notice: Laws in some communities may restrict the use of the features that remotely start the engine. For example, some laws may require a person using the remote start feature to have the vehicle in view when doing so, or limit the length of time a vehicle engine may idle. Please check local and state regulations for any requirements and restrictions on remote starting of vehicles and engine idling time.

WARNING!

Do not remote start vehicle in an enclosed environment (i.e., closed garage). Prolonged operation of a motor vehicle in an enclosed environment can cause a harmful build-up of carbon monoxide. Carbon monoxide is harmful to your health. Exposure to high levels of carbon monoxide can cause headaches, dizziness or in extreme cases unconsciousness and / or death. Do not leave children or animals unattended in a vehicle while using the remote start function.

CAUTION!

If the vehicle's windshield wipers are left on when the vehicle was last driven, then the wipers will turn on if the remote start function is activated. To avoid damage to the wiper blades (i.e., due to heavy ice or snow accumulated on the windshield), please always turn the vehicle's windshield wipers off when parking the vehicle.

ANDROID AUTO™

REQUIREMENTS:

- USB cable
- OS Android™ 5.0 or higher
- Compatible Android Phone
- Data and wireless plan for applicable features

BEFORE YOU BEGIN:

- Android Auto features may operate differently than on your phone.
- Message and data charges may apply when using Android Auto.
- Android Auto relies on the performance of your phone. If you experience performance issues:
 - Close all apps and then restart them or
 - Disconnect and then reconnect your phone
- Using the USB cable that was provided with your phone is recommended.

ANDROID AUTO SUPPORT



<https://support.google.com/androidauto/>

NOTE - Dual Voice Recognition:

1. Pressing Voice Recognition button once will use vehicle onboard for requests.
2. Pressing and Holding Voice Recognition button will use Android Auto for requests.

PHONE SETUP

Turn on Bluetooth® on your phone and connect the USB cable to your phone and the USB port on the vehicle.

Phone will prompt you to download the Android Auto app and update other needed apps (i.e. Google Maps™, Google Play Music™, Google Now™).

NOTE: Vehicle must be parked.

- Location mode setting should be set to High accuracy.
- Car and phone setup should be completed in one sitting. If phone setup needs to be resumed, recommend to Force Stop the Android Auto app on the Phone then reopen the app and accept the Disclaimer notifications.

CAR SETUP

1. Press the SETUP button.
2. Touch Device Connection.
3. Check the box for “Enable Android Auto”.
4. Connect your Android phone to the vehicle USB port. Agree to the notification and disclaimers on your phone then the “Android Auto” icon will appear confirming the setup.

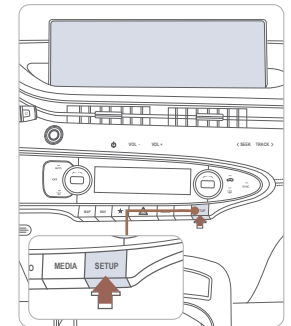

For more detailed information on how to operate Android Auto, please refer to your navigation manual.

For additional Android Auto support, please refer to the Android Auto Support Website
<https://support.google.com/androidauto/>

Android Auto, Google Play, Android, and other marks are trademarks of Google Inc.

APPLE CARPLAY™

REQUIREMENTS

- Apple Lightning® cable
- Latest iOS
- iPhone® 5 or above
- Data and wireless plan for applicable features

BEFORE YOU BEGIN

- Apple® CarPlay features may operate differently than on your phone.
- Message and data charges may apply when using Apple CarPlay.
- Apple CarPlay relies on the performance of your phone. If you experience performance issues:
 - Close all apps and then restart them or
 - Disconnect and then reconnect your phone
- Using the Apple Lightning cable that was provided with your phone is recommended.
- When Apple CarPlay is active, press and hold the voice recognition button to make your requests

PHONE SETUP

On your phone, go to Settings > General > CarPlay to allow CarPlay access.

On your phone, go to Settings > Siri and ensure Siri is turned ON.

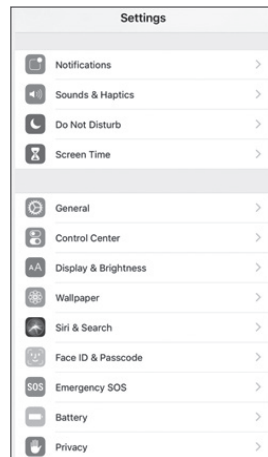

CAR SETUP

1. Press the SETUP button.
2. Touch Device Connection
3. Check the box for “Enable Apple CarPlay”.
4. Connect your Apple iPhone to the vehicle USB port then touch ‘OK’ when the pop-up message appears. The Apple CarPlay icon will now appear on the vehicle Home screen confirming the setup.



Apple CarPlay, Apple, and other marks are trademarks of Apple Inc.

DUAL VOICE RECOGNITION:

1. Pressing Voice Recognition button once will use vehicle onboard for requests.
2. Pressing and Holding Voice Recognition button will use Apple Carplay for requests.

CarPlay Home Screen

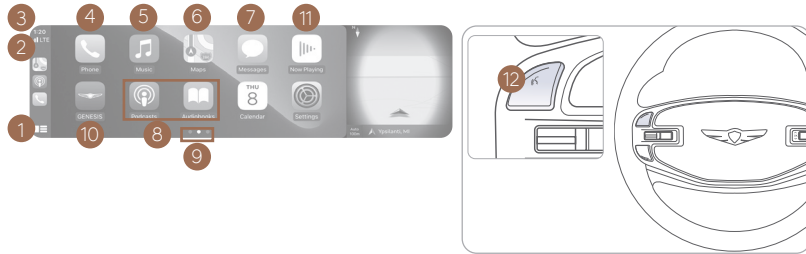

- | | |
|-------------------|----------------------------------|
| 1 HOME ICON | 7 MESSAGES |
| 2 CELLULAR SIGNAL | 8 3RD PARTY APPS |
| 3 PHONE TIME | 9 SCREEN PAGE INDICATOR |
| 4 PHONE | 10 EXIT TO HOME SCREEN |
| 5 APPLE MUSIC™ | 11 CURRENT CARPLAY AUDIO PLAYING |
| 6 APPLE MAPS | 12 VOICE RECOGNITION |

SIRI

Apple CarPlay uses Siri to perform many actions like sending messages, placing calls, and looking up/setting POI/Destinations. A Siri session can be initiated on any screen by:

1. Touch and hold the HOME icon 1 on the CarPlay screen or
2. Press and hold VOICE RECOGNITION 12 button.

Note: Ensure Siri feature is set to ON in your phone (Go to Settings > General > Siri).

3. Say any of the following commands;

- “Text <John Smith> ‘Call you later’” to send a text message.
- “Read text messages” to read available text message.
- “Call <John Smith>” to make a phone call.
- “Find <POI/Destination>” to locate a POI/Destination.

PHONE

Touch the PHONE 4 icon to access the Phone screen. Siri will automatically ask ‘Who you would like to call’ when the PHONE 4 icon is selected.

NOTE: Phone call sound quality is dependent on the wired connection. Using the Lightning cable that came with the phone is recommended.

APPLE MUSIC

Touch the APPLE MUSIC 5 icon to access the Apple Music screen.

APPLE MAPS

Touch the APPLE MAPS 6 icon to access the Apple Map screen.

MESSAGES

Touch the MESSAGES 7 icon to access the Message screen. Siri will automatically ask ‘To hear unread messages or create a new one’ when the MESSAGE icon is selected.

3rd PARTY APPS

Supported CarPlay apps that are downloaded on your phone will appear on the CarPlay screen. Touch the apps icons to access those supported apps.

NOTE: A list of the supported CarPlay supported apps can be found at <http://www.apple.com/ios/carplay/>

Ensure phone has latest version of the 3rd Party Apps.

NAVIGATION

Map position



- 1 Move to the Home Screen
- 2 Map view mode
- 3 Map Scale Display
- 4 Navigation Volume
- 5 Menu
- 6 Stop route/Resume route
- 7 Estimated arrival time and remaining distance
- 8 Current location and destination name display
- 9 Vehicle position mark
- 10 Route display
- 11 TBT (Turn by Turn): turns the TBT function on/off
- 12 Route: changes the route conditions when a route is set

NOTE: Map view can be changed by selecting Map view mode button.

NOTE: Described functions may change in future updates to improve convenience. Please check for the latest S/W version regularly.

POWER OUTLET

Front Outlet

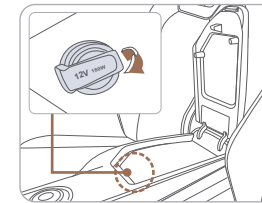

Luggage Compartment Outlet

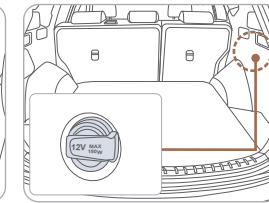

The power outlet is designed to provide power for mobile telephones or other devices designed to operate with vehicle electrical systems. The devices should draw less than 180 watts with the engine running.

USB PORTS

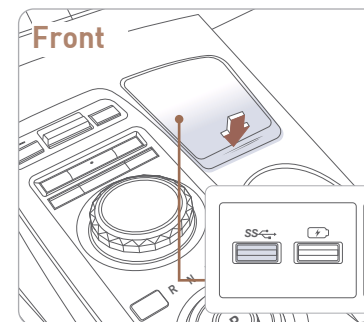

Plug in a USB cable or other media device to connect an external audio device and listen to it through the audio system in your vehicle.

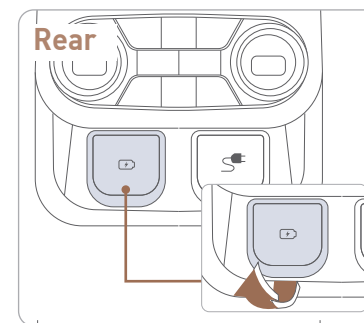

The rear USB charger is designed to recharge batteries of small size electrical devices using a USB cable. The AC inverter supplies 110 volts (180 watts) electric power to operate electric accessories or equipment.

WIRELESS CELLULAR PHONE CHARGING SYSTEM

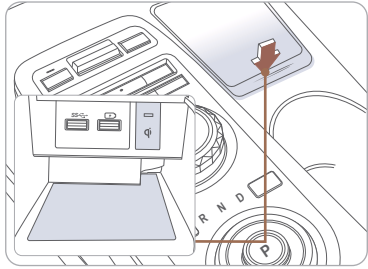

There is a wireless cellular phone charging system inside the front console. The system operates with all doors closed, and the ignition switch is in the ACC/ON position.

NOTE: The wireless cellular phone charging system supports only the Qi-enabled cellular phones (Qi).

NOTE: Do not place any metallic items such as coins, keys on the charger. Avoid putting credit cards, etc. on the charger as they might get damaged by the magnetic field.

RADIO



- 1 Moves to home screen or the previous screen.
- 2 Moves to home screen.
- 3 Menu – Displays pop-up menu of each mode
- 4 Band - Selects the desired radio band by pressing [FM], [AM] or [SiriusXM].
- 5 Voice Recognition - Moves to voice recognition screen.
- 6 Mode display - Shows the mode currently in play.
- 7 Frequency Dial – Touch or drag to tune to the desired station.
Press ☆ to add current station to the preset.

AUDIO CONTROL

1. Users can set the volume level of each source (FM, AM, SXM, USB, BT and so on) individually by adjusting volume knob.
2. Then AVN (Headunit) will save the last volume levels of each source in the system sound settings.
3. If users change the source, the volume will revert to the previously set volume for that source.

HOMELINK WIRELESS GARAGE CONTROL SYSTEM

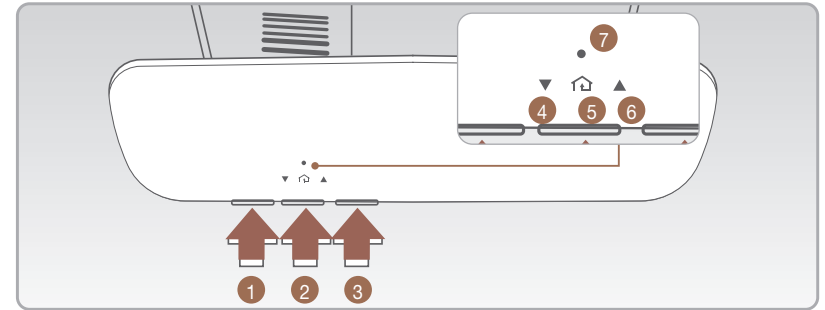

1. Press and release 1, 2 or 3 button.
 - If the indicator 7 is turned ON in Orange, go to Step 3 (programming mode)
 - If the indicator 7 is continuously turned ON or flashes in Green rapidly several times, go to Step 2 (erasing mode)
2. Press and hold the button you wish to program for approximately 15- 25 seconds until the LED flashes in Orange for several times.
3. Hold the Garage Door Opener Original Transmitter near the HomeLink Mirror.
4. Press the Original Transmitter button until the indicator 7 is turned continuously ON or flashes in Green for approximately 10 seconds and it indicates the programming is completed.

NOTE: If the indicator 7 flashes in Green continuously, but if the garage door opener does not operate, please continue to follow Rolling Code Programming steps below.

Two Way Communication

Some new garage door openers come equipped with a two-way communication feature. If your garage door opener has this feature, please also continue to follow the Rolling Code Programming steps below. For more information and programming tips on two-way communication please visit www.homelink.com/compatible/two-waycommunication or call (800)-355-3515.



Indicator 4 & 6:
 Flashes in orange → “Closing” & “Opening”
 Solid Green → “Closed” & “Opened”

NOTE: If your garage door opener has Two-Way Communication functionality, it is possible for HomeLink to stop functioning the garage door shortly after initial programming, if the Two-Way Communication Programming wasn’t properly completed. If you experience this, completing the “Programming a New HomeLink Button” and “Two-Way Communication Programming” will restore door operation.

Rolling Code Programming

- You may need a ladder to access your garage door opener.
- You may need help from a second person.
- Be prepared some of the steps are time sensitive.

1. Firmly press and release the “Learn”, “Smart”, or “Program” button of garage door opener on the ceiling while the indicator 7 flashes in Green. Once the button is pressed, you have approximately 30 seconds to initiate the next step.

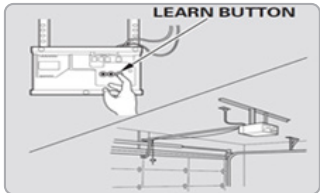

2. Return to the vehicle and firmly press the HomeLink button, hold for two seconds and release the button up to three times. Do not press the HomeLink button rapidly. At this point programming is complete and your device should operate.

For more detailed information, please refer to your Owner’s manual or visit www.homelink.com or call (800) 355-3515



SHIFT BY WIRE (Electronic type shifter)

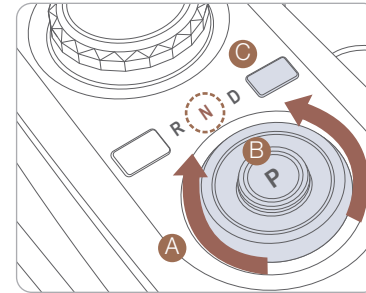

To shift the gear to P (Park), press the P button while depressing the brake pedal.

To shift the gear to N (Neutral), rotate the shift dial clockwise from R (Reverse) or counterclockwise from D (Drive) while depressing the brake pedal.

A Rotary shifter (Rotary gear shift dial), B Park button, C Release Cap

To shift the gear to R (Rear), rotate the shift dial counterclockwise while depressing the brake pedal.

Paddle Shifter (Manual Shift Mode)

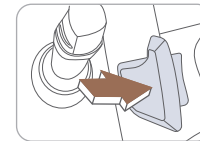

Press (-) to downshift

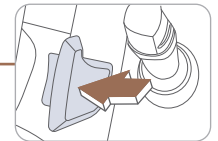
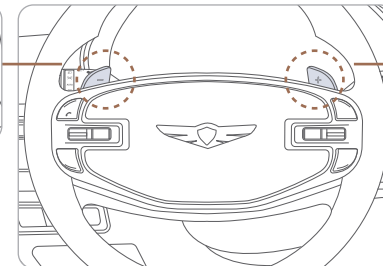

Press (+) to upshift

The Paddle shifter is available when the shift lever is in the D position.

Press the [+] or [-] paddle shifter once to shift up or down one gear.

NOTE: To exit manual shift mode, pull and hold (+) paddle shifter for more than 3sec.

ELECTRONIC STABILITY CONTROL (ESC)

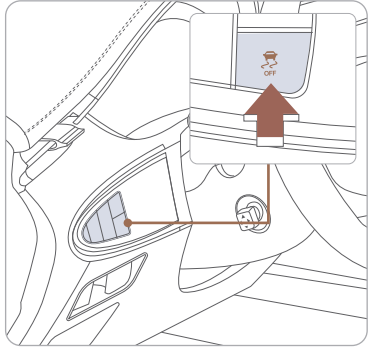

The ESC system is an electronic system designed to help the driver maintain vehicle control under adverse conditions. Press  to turn ESC on or off.

FORWARD COLLISION-AVOIDANCE ASSIST (FCA)

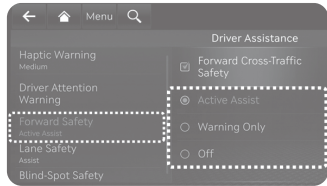

Forward Collision-Avoidance Assist is designed to help detect and monitor the vehicle ahead or help detect a pedestrian or cyclist in the roadway and warn the driver that a collision is imminent with a warning message, an audible warning and apply emergency braking.

Active Assist: Forward Collision-Avoidance Assist will warn the driver with a warning message, an audible warning and steering wheel vibration depending on the collision risk levels. Braking assist or steering assist will be applied depending on the collision risk.

Warning Only: Forward Collision-Avoidance Assist will warn the driver with a warning message, an audible warning and steering wheel vibration depending on the collision risk levels. Braking and steering will not be assisted. The driver must apply the brake pedal or steer the vehicle if necessary.

Off: Forward Collision-Avoidance Assist will turn off. The warning light will illuminate on the cluster.

LANE KEEPING ASSIST (LKA)

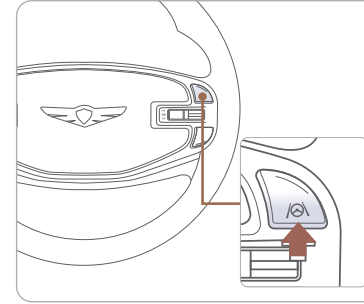

Lane Keeping Assist is designed to help detect lane markings (or road edges) while driving over a certain speed. Lane Keeping Assist will warn the driver if the vehicle leaves the lane without using the turn signal, or will automatically assist the driver's steering to help prevent the vehicle from departing the lane.

- To turn LKA on, press and hold the Lane Driving Assist button
- To turn LKA off, press and hold the button again.

LKA operates only when the vehicle speed is above 40 mph and when the  in the instrument cluster is green. LKA will not operate properly if the following conditions are present:

- the lane line is not clear
- on sharp bend in a road
- heavy fog

Refer to the Owner's Manual for more detailed information.

NOTE: During operation, you may feel the sensation of steering wheel movement. Depending on the road condition (gradient), the deflection driving may occur.

BLIND-SPOT COLLISION-AVOIDANCE ASSIST (BCA)

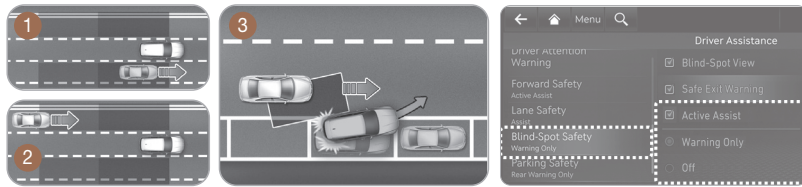

Blind-Spot Collision-Avoidance Assist is designed to help detect and monitor approaching vehicles in the driver's blind spot area and warn the driver of a possible collision with a warning message and audible warning.

In addition, if there is a risk of collision when changing lanes or driving forward out of a parking space, Blind-Spot Collision-Avoidance Assist can help avoid a collision by applying the brake.

DRIVER ATTENTION WARNING (DAW)

Driver Attention Warning can help determine the driver's attention level by analyzing driving pattern and driving time while vehicle is being driven. Driver Attention Warning will recommend a break when the driver's attention level falls below a certain level.

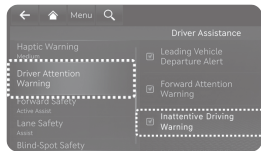

- With the engine on, select or deselect 'Driver Assistance → Driver Attention Warning' from the Settings menu to set whether or not to use each function.

Inattentive Driving Warning - If this is selected, Driver Attention Warning will inform the driver the driver's attention level and will recommend taking a break when the level falls below a certain level.

Leading Vehicle Departure Alert - If this is selected, the function will inform the driver when the front vehicle departs from a stop.

SMART CRUISE CONTROL (SCC)

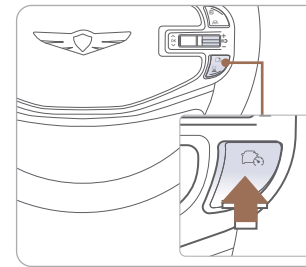

Smart Cruise Control is designed to help detect the vehicle ahead and help maintain the desired speed and minimum distance between the vehicle ahead.

To turn on SCC:

1. Press the Driving Assist button to turn on SCC. The speed will be set to the current speed on the cluster.
2. If there is no vehicle in front of you, the set speed will be maintained, but if there is a vehicle in front of you, the speed may decrease to maintain the distance to the vehicle ahead. If the vehicle ahead accelerates, your vehicle will accelerate.

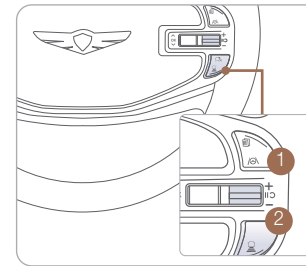

To set vehicle distance

Each time the button is pressed, the vehicle to vehicle distance changes as follows:

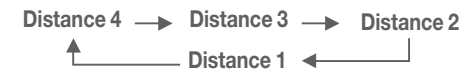

Adjusting the vehicle speed

1. Push '+' switch (1) UP to increase cruising speed.
2. Push '-' switch (2) DOWN to decrease cruising speed.

NOTE: Quick push up/down will change speed by 1 mph. Holding switch up/down will change speed by 5 mph.

To Cancel Smart Cruise Control

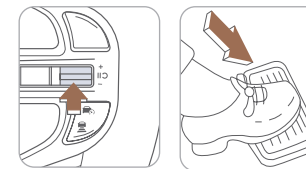

To temporarily cancel SCC

Press the switch or depress the brake pedal to temporarily cancel SCC.

To turn off the SCC

Press the Driving Assist button to turn SCC off.

LANE FOLLOWING ASSIST (LFA)

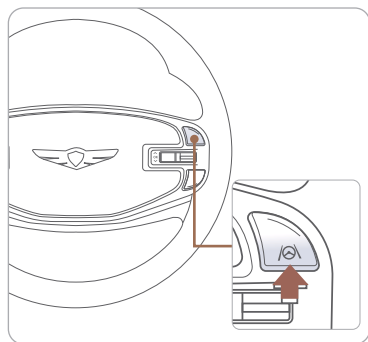

Lane Following Assist is designed to help detect lane markings and/or vehicles on the road, and assists the driver's steering to help keep the vehicle between lanes.

To activate LFA:

With the engine on, shortly press the Lane Driving Assist button located on the steering wheel to turn on Lane Following Assist. The white or green  indicator light will illuminate on the cluster. Press the button again to turn off.

HIGHWAY DRIVING ASSIST (HDA)

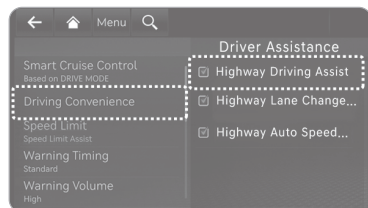

Highway Driving Assist is designed to help detect vehicles and lanes ahead, and help maintain distance from the vehicle ahead, maintain the set speed, and help center the vehicle between lanes while driving on the highway.

With the Engine Start/Stop button in the ON position, select or deselect 'Driver Assistance → Driving Convenience' from the setting menu to activate this setting.

NOTE: If the engine is turned off then on again, the system maintains the last setting.

Operation :

- Driving on the highway main road.
 - Vehicle speed is under 120 mph (200 km/h).
- Press the Driving Assist button on the steering wheel.
 - If entering the main road of highways while SCC and LFA is operating, HDA will be automatically activated.

If HDA is operating, the indicator on the cluster will illuminate green.

REAR VIEW MONITOR

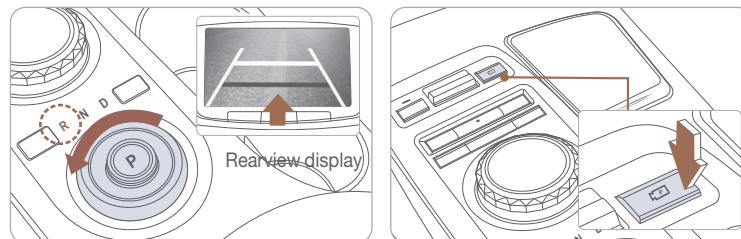

Rear View Monitor will show the area behind the vehicle to assist you when parking or backing up.

Shift the gear to R (Reverse), the rear view will appear on the screen, or press the Parking/View button while the gear is in P (Park), the rear view will appear on the screen.

NOTE: Rearview display is selectable, see Owner's Manual for further details.

The image displayed on the screen may become difficult to see under the following conditions:

- In the dark or at night.
 - When it is raining, or when water droplets are on the camera.
 - When the sun or the beam of headlights are shining into the camera lens.
- Use care to keep the camera lens clean and avoid applying any type of solvents, car wax, or window cleaners to the camera lens. If the lens becomes dirty, wipe the lens with a clean, soft cloth.

REMOTE START PARKING ASSIST (RSPA) (if equipped)

Remote Start Parking Assist uses vehicle sensors to help the driver park and exit parking spaces remotely from inside the vehicle by controlling steering wheel, vehicle speed, and gearshifts.

1. With the engine turned on, depress the brake pedal and shift the gear to D (Drive) or N (Neutral)
2. Press and hold the Parking/View button to turn on

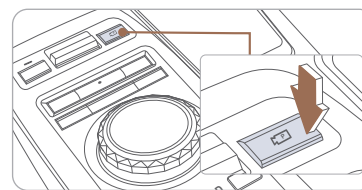

Follow the instructions on the infotainment screen.

FORWARD/REVERSE PARKING DISTANCE WARNING (PDW) -

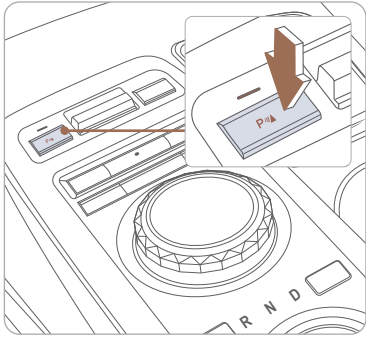

NOTE: Front Parking Distance Warning will not warn if button indicator light off.

Forward/Reverse Parking Distance Warning can help warn the driver if an obstacle is detected within a certain distance when the vehicle is moving forward or in reverse at low speeds.

Press the Parking Safety (P) button to turn on Forward/Reverse Parking Distance Warning. Press the button again to turn off the function.

When Forward/Reverse Parking Distance Warning is off (button indicator light off), if you shift the gear to R (Reverse), Forward/Reverse Parking Distance Warning will automatically turn on.

Parking Distance Warning does not operate when the vehicle's forward speed is above 6 mph (10 km/h).

WARNING TIMING AND VOLUME

Setting Warning Timing: The initial warning activation time can be adjusted in the settings menu: Setup -> Vehicle -> Driver Assistance -> Warning Timing -> Standard or Late

Setting Warning Volume: The warning volume of alerts can be customized by the driver by going to the settings menu: Setup -> Vehicle -> Driver Assistance -> Warning Volume -> High, Medium, Low, or Off

TIRE PRESSURE MONITORING SYSTEM (TPMS)

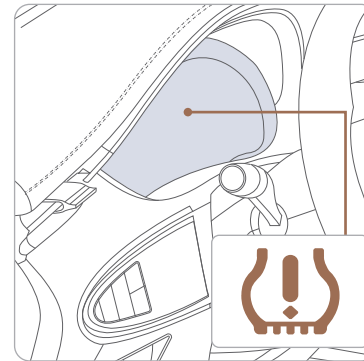

Low Tire Pressure Indicator / TPMS Malfunction Indicator

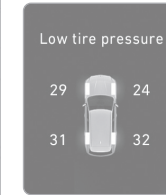

NOTE: Vehicle must be driven for accurate tire pressure reading.

Low Tire Pressure Position Telltale and Tire Pressure Telltale (Shown on the LCD display)

LOW TIRE PRESSURE INDICATOR

Illuminates if one or more of your tires are significantly under-inflated.

TPMS MALFUNCTION INDICATOR

Blinks for approximately one minute, then remains illuminated when there is a malfunction with the TPMS. Inspect all tires and adjust tire pressure to specification. If the lamp remains illuminated, have the system checked by an authorized retailer of Genesis Brand Products as soon as possible.

LOW TIRE PRESSURE POSITION INDICATOR AND TIRE PRESSURE INDICATOR (LCD DISPLAY)

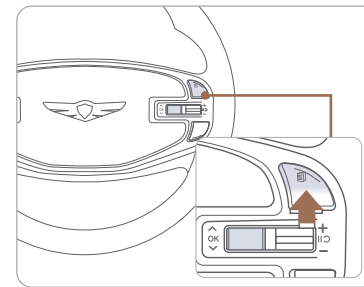

To access the TPMS menu within the LCD display, press the Assist mode button on the steering wheel to display tire pressure.

Tire pressures will display after driving a short distance. If a tire pressure drops lower than predetermined specification, the Low Tire Pressure Indicator (⚠) will illuminate and the LCD (⚠) display will indicate tire(s) requiring air.

ELECTRIC PARKING BRAKE (EPB)

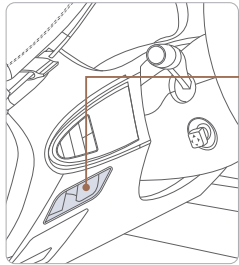

Applying

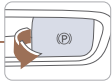

Releasing

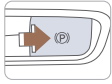
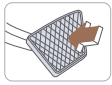

NOTE: If necessary, emergency braking is possible by pulling and holding the EPB switch.

To apply EPB (Electronic Parking Brake)

1. Depress and hold the brake pedal.
2. Pull up the EPB switch. Make sure the Parking Brake warning light comes on.

To release EPB (Electronic Parking Brake)

1. Press the Engine Start/Stop button to the ON or START position.
2. Press the EPB switch while depressing the brake pedal. Make sure the Parking Brake warning light goes off.

AUTO HOLD

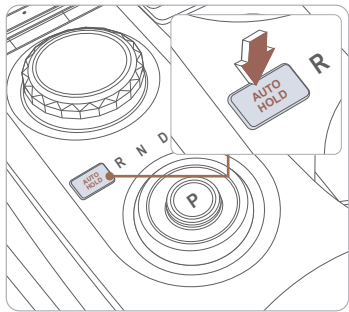

The Auto Hold feature assists in steep hill areas. It holds the brake until the accelerator pedal is pressed.

**WHITE
AUTO
HOLD**

1. Press the AUTO HOLD switch.

**GREEN
AUTO
HOLD**

2. Stop the vehicle by pressing the brake pedal. The brakes will remain engaged even if the brake pedal is released.

**WHITE
AUTO
HOLD**

3. The brakes will release when the accelerator pedal is pressed with transmission in D, R or manual mode.

To cancel the AUTO HOLD operation, press the AUTO HOLD switch again.

IDLE STOP AND GO (ISG)

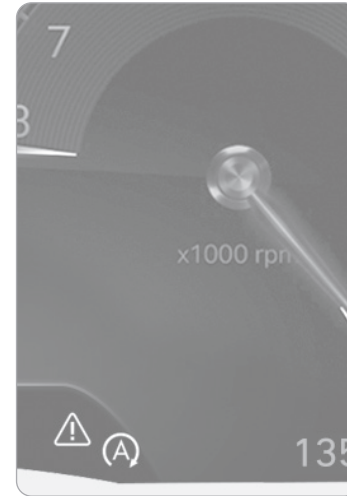

The ISG system will automatically shut off the engine when the vehicle is at a standstill (i.e. red stop light, stop sign, and traffic jam) to increase vehicle's fuel economy and reduce exhaust gas emissions. The auto stop indicator will illuminate in green on the instrument cluster when activated. To restart the engine in auto stop mode, release the brake pedal and press on the accelerator. The auto stop indicator goes OFF on the instrument cluster once the engine is restarted.

Prerequisite for activation:

- The driver's seatbelt is fastened.
- The driver's door and the hood are closed.
- The brake pressure is adequate.
- The battery is sufficiently charged.
- The outside temperature is between 14°F and 95°F (-10°C and 35°C).
- Engine is warmed up.
- The incline is gradual.
- Steering wheel is turned less than 180 degrees.
- Shift lever is in DRIVE or NEUTRAL.

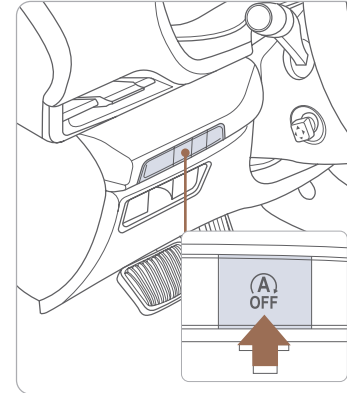

NOTE: The engine will not shut off if the prerequisites are not satisfied. In that case, the Auto Stop indicator will illuminate in yellow on the instrument cluster.

To deactivate

Press the ISG OFF button, indicator illuminates.

To activate

Press the ISG OFF button, indicator turns OFF.

FINGERPRINT AUTHENTICATION SYSTEM (if equipped)

Fingerprint authentication system allows the driver to start the engine, have access to personal information, unlock profile and exit valet mode with a enrolled fingerprint.

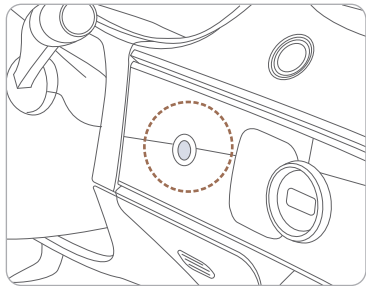

Fingerprint Authentication System Settings

To use the system, the driver's fingerprint should be enrolled in the driver's profile. The drivers can set or delete their fingerprint through the infotainment system. Follow the following procedure.

1. Turn on the vehicle with a smart key.
2. Select 'Setup > User Profile Settings > Driver 1 > Fingerprint identification > Set/Delete Fingerprint > Set' in the infotainment system screen.
3. Place your finger that you wish to enroll on the fingerprint sensor.
4. Following the instructions, place several parts of your fingerprint until the scanning process is complete.
5. Once the scanning process is completed, the message 'Saving fingerprint...' appears and the fingerprint enrollment process is proceeded.
6. When the fingerprint enrollment process is completed in the vehicle, the status is displayed on the infotainment system.

DIGITAL KEY PAIRING (if equipped)

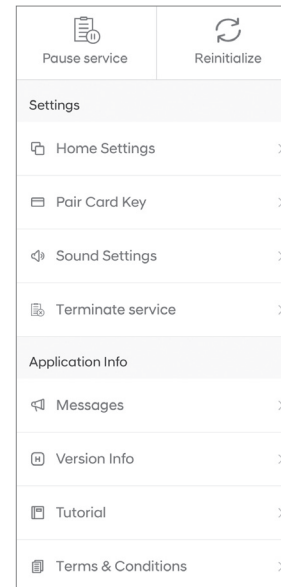
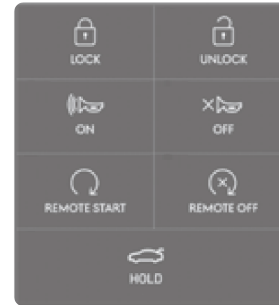

Genesis Digital Key allows drivers to start the engine of their car using a smartphone app and Near-Field Communication (NFC). Genesis Digital Key provides many of the same functions as your physical key. To pair your smartphone, complete the following steps:

1. Login to the Genesis Digital Key Application using your MyGenesis username and password
2. Start the vehicle with the proximity key
3. Pair the phone to the vehicle as follows:
 - Navigation Vehicles: Settings -> Vehicle -> Digital Key -> Smartphone Key -> Save
 - Display Audio: Instrument Cluster User Settings Mode -> Digital Key -> Smartphone Key -> Save
4. Open the Genesis Digital Key Application on the primary user's smartphone. Select the + Icon on the main screen of the smartphone app.
5. Place the smartphone on the Wireless Phone Charger in the vehicle and the process will begin automatically
6. Once the screen in the vehicle says saved, your Digital Key is ready to use.

NOTE: This application is only available for Android users.

If the NFC card is lost or stolen, please contact your local Genesis dealer for replacement.

NEAR FIELD COMMUNICATION (NFC)



Pair Card Key authentication

Authenticate using NFC

Authenticate using BLE

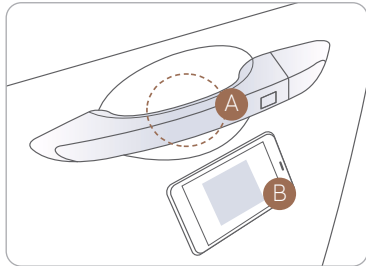

To lock/unlock your vehicle using the NFC key card, hold the key card up to the center of the door handle **A**.

If you try to lock your vehicle with the NFC card under the following conditions, it will not work:

- The Smart Key is in the vehicle.
- The POWER button is in ACC or ON position.
- Any of the doors, hood and trunk are open.

NOTE: If you overlap and use the key card with other NFC-enabled cards such as a transportation card or credit card, it will not work.

*For security reasons, the vehicle can only have one NFC key card paired to it at one time. Any time that a new Key card is paired to the car it will disable the previously paired Key Card .

OIL CHANGE REMINDER (if equipped)

Oil change reminder predicts engine oil life based on driving conditions and alerts when the next oil change is required.

Oil remaining life will begin initially at 100% and alert of an oil change starting at 5%

1st Engine oil change warning when oil life reaches 5%

- A engine oil change message will display on the cluster for 4 seconds when engine is turned on.

2nd Engine oil change warning when oil life reaches 1%

- A engine oil change message will display on the cluster for 10 seconds when engine is turned on.

3rd Engine oil change warning when oil life is less than 1%

- A warning light will appear as well as an engine oil change message on the cluster for 10 seconds when engine is turned on.
- The warning light will remain on until the engine oil is changed and oil change reminder is reset.
- Oil change reminder “Reset” should only occur when the engine oil is changed. Resetting without oil change will result in notification function not displaying correctly. In such case, engine oil change needs to occur within 4,970 miles of the most recent oil change.
- Engine oil needs to be changed according to change cycle noted during inspection even when engine oil life span warning does not show.
- The system assumes that engine oil is normally added if low, oil level should be checked regularly.

To check the current engine oil life status:

1. Setup
2. Vehicle
3. Cluster
4. Oil Change Reminder

Program Coverage Summary

Genesis Service Valet is included for the first 3 years or 36,000 miles, whichever comes first, of ownership.			
Complimentary Services	Service Valet	Complimentary Loaner Vehicle	Maintenance
Original Owner or Lessee	Yes	Yes	Yes
Subsequent Owner or Lessee	Warranty Only	Warranty Only	No

See below for program terms and conditions.

SERVICE VALET

Service Valet is available while your vehicle is receiving complimentary maintenance, wear items, or warranty repairs by an authorized Genesis retailer. Simply contact your authorized Genesis retailer's Service Experience Manager or contact the Customer Care Center at 844-340-9741 to make your appointment. The retailer will work with you to arrange your pickup and delivery time and location.

- Valet appointments must be made at least 2 business days in advance.
- Valet area of coverage is valid only within an estimated 1 hour drive time distance (based on traffic, weather, and road conditions) from the participating retailer location to the pickup/delivery location.
- Valet pickup and delivery must occur during normal business hours. After-hours pickup and delivery are at the discretion of your participating retailer.
- You must notify your Genesis Service Experience Manager 1 business day in advance if location or time of valet services changes. If a change or cancellation is not made at least 1 business day in advance, you may be charged a fee, or Service Valet may be cancelled.
- You will be charged a fee if you elect to extend the use of the courtesy replacement vehicle or delay the delivery of your vehicle.
- Prior to or at the time of your vehicle pickup, you will need to provide your valet with the following information if a courtesy replacement vehicle is needed:
 - Insurance company name, policy number, and expiration date
 - Driver's license number, state, expiration, and date of birth
 - Credit card number and expiration date (standard requirement for rental car use)
 - The above information for any additional drivers

Genesis brand vehicle owner must provide the valet with the Genesis brand vehicle that is currently registered in compliance with local and state laws. Road tolls incurred during the Service Valet may be charged to the vehicle owner.

COMPLIMENTARY LOANER VEHICLE

We come to you and provide you with alternative transportation. While your vehicle is being serviced under this program, qualified drivers will be provided a courtesy replacement Genesis brand vehicle at no additional cost. You must be at least 25 years of age (in most states) with a valid driver's license to drive a loaner vehicle. Please provide your Service Advocate with the following information:

- Insurance company name, policy number, and expiration date
- Driver's license number, state, expiration and birth date
- Credit card number and expiration date (standard requirement for rental car use)
- The above information for any additional drivers

COMPLIMENTARY MAINTENANCE COVERAGE

Vehicle Eligibility

For original retail owners of the Genesis vehicle, all factory-recommended scheduled maintenance are covered for the first 3 years or 36,000 miles, whichever comes first. The Service Valet Program is applicable to all 2017 - 2019 model year Genesis brand vehicle United States specification vehicles purchased in the United States from authorized Genesis retailers. The program is not in effect outside of the United States.

- Vehicle coverage begins on the date of first retail sale. Fleet vehicles are excluded from this program.
- If the vehicle becomes damaged (such as by accident, fire, act of nature, etc.) and is subsequently titled salvaged, flooded, or reconstructed, it is no longer eligible for the benefits of the Genesis G80 complimentary maintenance Program.

Guidelines for Scheduling Maintenance

The Service Valet Program covers factory-recommended scheduled maintenance for the first 3 years or 36,000 miles, whichever comes first. Covered maintenance costs include all labor and parts necessary to complete the factory recommended service. Having your vehicle serviced at the specified time/mile intervals is critical in maintaining long-term durability. Failure to have your vehicle serviced at the specified interval may invalidate the warranty under certain circumstances.

If for any reason a service is missed, the authorized Genesis retailer will perform the next or missed major service.

Some owners may wish to have their oil changed more frequently. The customer must pay for any additional services performed on the vehicle. Service procedures not specifically referenced in the Genesis Customer Care Quick Reference Guide must be preauthorized by a Genesis District Parts and Service Manager.

