



# GETTING STARTED GUIDE

**GENESIS GV60**



# GETTING STARTED GUIDE

## AUDIO, CONNECTIVITY, AND NAVIGATION

Thank you for joining the Genesis family. This easy-to-follow guide will show you how to use various Genesis GV60 features and how to adjust their settings to your preferences. We hope you enjoy the distinctive luxury of a customized and convenient ownership experience.

### TABLE OF CONTENTS

Phone Projection	3
Phone Pairing	4
Custom Button	5
Making a Call	6
Navigation	8
Dynamic Voice Recognition	11
Dual Voice Recognition	12
Map Displays	13
Advanced Driver Assistance Systems	15
Convenience Settings/Features	17
Control Knob	21

# PHONE PROJECTION

Android Auto™ and Apple CarPlay® allow you to access the most commonly used smartphone features, including calling, navigation, text messaging, and playing music all from your driver's seat.



1. The vehicle's shifter must be in 'Park.'

Then 'Connect' a USB-C data cable from your phone to the vehicle's USB-C port.\*

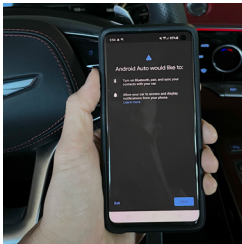

ANDROID AUTO



APPLE CARPLAY

2. 'Allow permission' from your phone to connect to your vehicle.

Please note that your phone must be unlocked.



ANDROID AUTO



APPLE CARPLAY

3. Enjoy using the applications displayed on your vehicle's multimedia screen.

## Note

Android Auto users will be prompted to view a tutorial. Select your option and proceed.

\*USB-C data port will typically be located in or near the front in-dash console. Check your vehicle's owner's manual for specific location. Data cable for iOS device is required for Apple CarPlay. OEM data cables are recommended. Apple CarPlay is a registered trademark of Apple Inc. Android Auto is a trademark of Google LLC.

# PHONE PAIRING

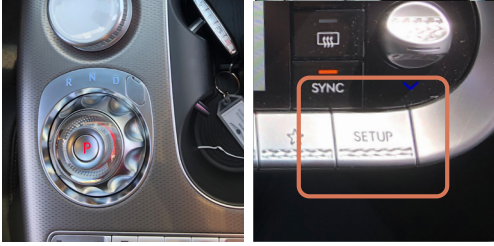

1. The vehicle's shifter must be in 'Park.'  
Then press the 'Setup' button.

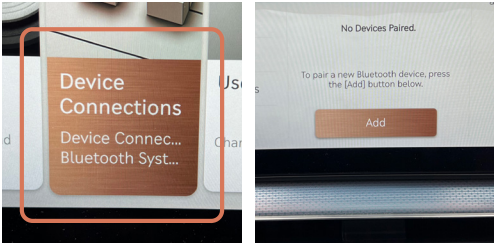

2. Select 'Device Connections' on the screen.  
Then press 'Add.'

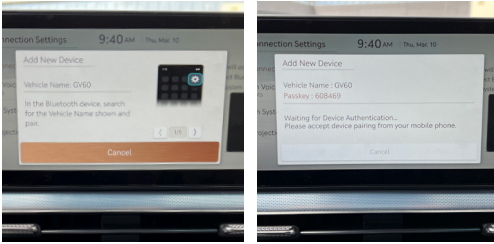

3. Turn on your phone's 'Bluetooth,' select the device (GV60) found by your phone, and follow any additional prompts on your phone.

## Depending on the phone manufacturer and model:

- Some phones may request approval to download contacts; this process will take a few minutes
- Contact list may start with First or Last Name, depending on phone models
- Some phones may require additional confirmation to allow contacts to sync

**Allow Contacts and Favorites Sync?**

Your car may request your contacts, phone favorites, and recent phone calls over Bluetooth. Do you wish to allow this?

<a href="#" style="color: blue; text-decoration: none;">Don't Allow</a>	<a href="#" style="color: blue; text-decoration: none;">Allow</a>
-------------------------------------------------------------------------	-------------------------------------------------------------------

## Note

Bluetooth settings can be found in the 'Settings' app on most smartphones. Refer to your phone's owner's manual or visit [GenesisBluetooth.com](http://GenesisBluetooth.com) for more information.

If your phone is supported, then your contact list may be transferred to your vehicle automatically.

# CUSTOM BUTTON

## INITIAL SETUP

The Custom Button (☆) is easy to set up and use so that you can enjoy your favorite features with just a touch of a button. Learn how to set up your Custom Button by reviewing the steps below.

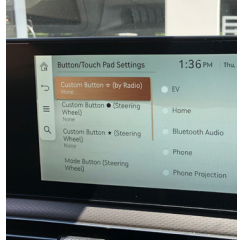
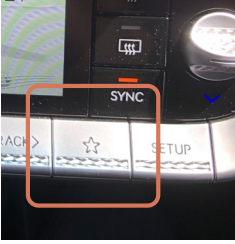

1. The vehicle's shifter must be in 'Park.'  
Then press the 'Custom Button.'\*



2. Select from the listed options\*\* to set as your custom button.  
For example, select 'Phone.'

\*Button location may differ from the image shown.

\*\*Listed options may differ from the image shown.

# MAKING A CALL

## BY VOICE COMMANDS USING BLUETOOTH

### Before you start

Make sure your phone is connected to your vehicle and your phone contacts have been downloaded to the vehicle. If this has not been done, please follow the instructions on page 4.



1. Press the 'Push to Talk' button on the steering wheel.\*

You will hear "Please say a command," followed by a beep.



2. After the beep, say the command "Call" followed by the name of the desired contact.

Example: "Call John Smith"



3. The selected number will be dialed and your contact's name and phone number will appear on the screen.



4. To end the call, press the 'Call' button located on the steering wheel.

\*Steering wheel appearance may differ depending on trim level.

# MAKING A CALL

## COMMON VOICE COMMANDS



To enable voice command, press the 'Push to Talk' button located on the steering wheel.

### **Here are a few common voice commands to use after your phone has been paired:**

"Help" provides guidance on commands that can be used within the current function.

Say "Call" to initiate a call followed by saying the name of the saved contact with whom you wish to speak. For example: "Call John Smith."

"Dial" makes a call by dialing the spoken numbers.

For example: "Dial 1-800-633-5151."

### **Note**

Compatibility and performance may vary based on your phone, the phone's software, and your wireless carrier.

# NAVIGATION

## FINDING A DESTINATION USING VOICE COMMANDS



1. Press the 'Push to Talk' button located on the steering wheel.

You will hear "Please say a command," followed by a beep. After the beep, say the command "Find Coffee Shop."

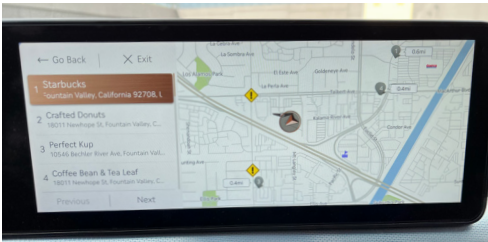

2. The results will be listed on the screen.

Say the line item number (for example: "One") to make your selection.



3. Select either the recommended or alternate route. The destination route will display on the screen and route guidance will begin.

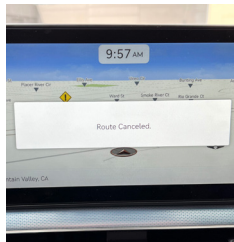

4. Press the 'Push to Talk' button located on the steering wheel and say "Cancel Route" to stop route guidance.

# NAVIGATION

## INPUTTING A DESTINATION

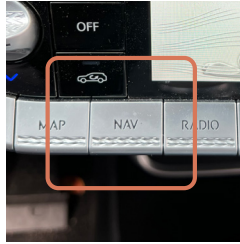

1. The vehicle must be in 'Park.'\*  
Press the 'Nav' button.\*\*



2. Select 'Search.'



3. Enter the address of your destination or the name of your POI and hit 'OK' or select destination from results.

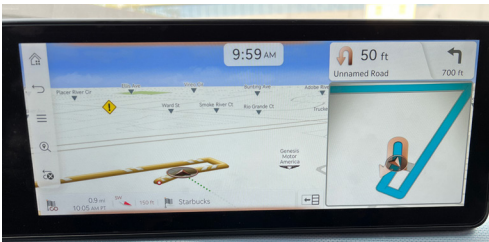

4. The route to your destination will be displayed on the map. Select 'Set as Destination' to begin your route.

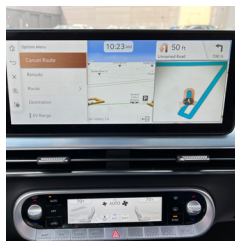

5. Press the 'Push to Talk' button located on the steering wheel and say "Cancel Route" after the prompt to stop route guidance.

\*Manual destination input is only available when the vehicle is in 'Park.'

\*\*Button location may differ from the image shown.

# NAVIGATION

## COMMON VOICE COMMANDS



To start voice command, press the 'Push to Talk'\* button located on the steering wheel.

### Here are a few common voice commands available to use:

"Help" provides guidance on commands that can be used within the current function.

Say "Find <Address>" to search for an address and set it as a destination. For example: "300 (Three-Zero-Zero) Main Street, Fountain Valley."

"Find <POI>" searches for the point of interest specified. For example: "Find Banks."

"Go Home/To Work" sets the destination to your home or work/office. Your home or work address must be set in the navigation system.

"Cancel Route" cancels the route to the set destination and exits guidance.

"Police Station/Hospital" displays a list of the nearest police stations or hospitals.

\*The display, button, and/or icon locations may differ from the images shown.

# DYNAMIC VOICE RECOGNITION

Your Genesis is equipped with Dynamic Voice Control, which allows you to use voice commands to control your vehicle's windows, climate, radio, navigation, and more. Additional POI and Internet search functions are available with a GCS subscription. To explore these commands, follow the instructions below.



1. Press the 'Push to Talk' button.

## Dynamic Voice Recognition Features Include:

- **Phone** Change Bluetooth device, make calls, and dial by number.
- **Radio** Tune to FM/AM, SiriusXM, or to a custom channel.
- **Vehicle Controls** Commands for climate controls, liftgate, seat, window, and steering wheel.
- **Navigation** Search for and find addresses located in the state or province your car is currently in. Navigate to saved places, access traffic information, turn guidance off, etc.
- **Setting Search** Search for certain vehicle setting screens based on a voice command.
- **HOUNDIFY** Access information on weather, sports, date/time, and stocks.

# DUAL VOICE RECOGNITION

**Follow these simple instructions to toggle between your vehicle's voice recognition and Android Auto's or Apple CarPlay's voice recognition.**

Dynamic Voice Recognition varies by unit. Speak in a normal voice and minimize background noise for best results. See Owner's Manual for details and limitations.



## **Genesis Voice Recognition:**

Press the 'Push to Talk' button and say a command.

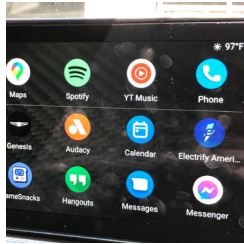

ANDROID AUTO



APPLE CARPLAY

## **Android Auto or Apple CarPlay:**

First, make sure your phone is connected to Android Auto or Apple CarPlay. Then hold down the 'Push to Talk' button until prompted by Android Auto or Apple CarPlay to provide a command.

## **Long-Press vs. Short-Press Voice Recognition**

- Long press of 'Push to Talk' button triggers phone projection voice recognition by Siri or Google Voice
- Short press of 'Push to Talk' button triggers built-in phone projection voice

# MAP DISPLAYS

Customize the way that your Genesis displays maps by following the steps below.

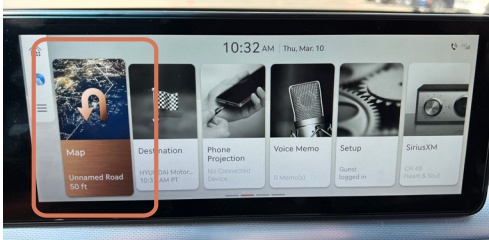

1. The vehicle's shifter must be in 'Park.'  
Then select 'Map' on the screen.

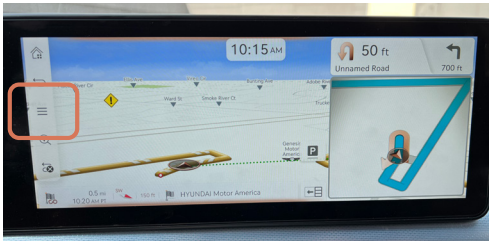

2. Tap the three lines on the left side of the screen.

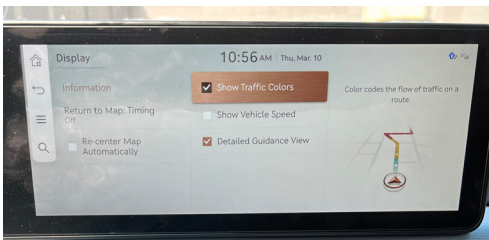

3. Checking 'Show Traffic Colors' will show traffic conditions on your map.



4. Press the 'Nav' button to modify additional settings.

# MAP DISPLAYS

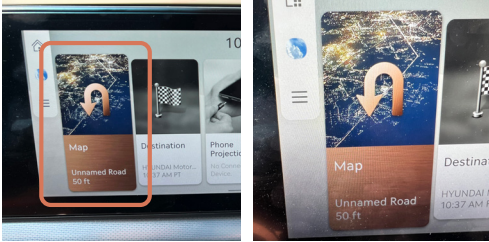

5. Select 'Map' directly.

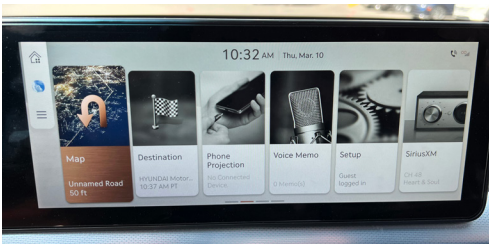

6. Select each category on the menu to set your map preferences.

# ADVANCED DRIVER ASSISTANCE SYSTEMS

Your Genesis is equipped with Advanced Driver Assistance Systems\* to help you along the way. To access the settings for these features, follow the instructions below.



1. The vehicle's shifter must be in 'Park.'  
Then press the 'Setup' button.

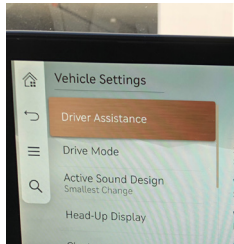
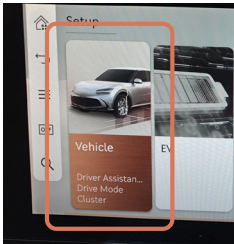

2. Select 'Vehicle.'  
Then select 'Driver Assistance.'

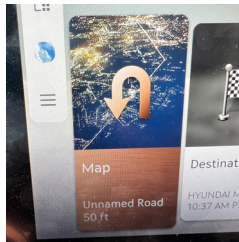

3. Select a feature on the menu to set its properties.

## Advanced Driver Assistance Systems include:

- Smart Cruise Control
- Driving Convenience
- Warning Timing
- Warning Volume
- Haptic Warning
- Driver Attention Warning
- Forward Safety
- Lane Safety
- Blind-Spot Safety
- Parking Safety

\*The Advanced Driver Assistance System warning and alerts only serve to inform the driver of potential hazards. They do not detect and provide an alert in every situation. It is the driver's responsibility to remain alert at all times. See Owner's Manual for details and limitations about each of these advanced driver assistance systems.

# ADVANCED DRIVER ASSISTANCE SYSTEMS

## NEW FEATURES

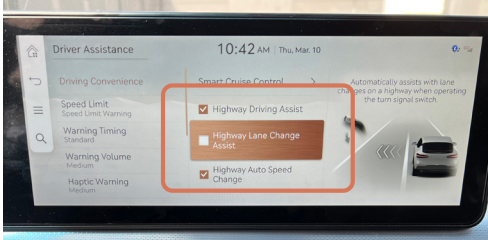

### Highway Lane Change Assist

The Highway Lane Change Assist function automatically helps with steering to help prevent the vehicle from leaving the lane.

Highway Lane Change Assist (HLCA), when used in conjunction with Highway Driving Assist II, can help the driver change lanes when the turn signal indicator is held above the locked position on the steering column. HLCA can help the driver check blind spots for other vehicles and can help provide steering assistance during the lane change. There are limitations to the function, detection, range, and clarity of the system. HLCA may not function correctly if one or more of the parking sensors is damaged, dirty, or covered, or if weather conditions (heavy rain, snow, or fog) are interfering with the sensor operation. Always drive carefully and use extreme caution when other vehicles are present. See Owner's Manual for further details and limitations.



### Intelligent Speed Limit Assist (ISLA) (if equipped)

The Intelligent Speed Limit Assist uses information from the detected road sign and navigation system to inform the driver of the speed limit and additional information of the current road. When activated, it also helps the driver maintain within the speed limit of the road by adjusting the vehicle's speed.

Intelligent Speed Limit Assist (ISLA) can help the driver maintain cruise control speed limit using speed limit sign recognition. ISLA cannot detect all speed limit signs, including when speed limit signage is obscured or beyond the camera's field of view. Driver remains responsible to observe posted speeds. See Owner's Manual for further details and limitations.

# CONVENIENCE SETTINGS/FEATURES

## Fingerprint Authentication System (if equipped)

The fingerprint authentication system allows the driver to start the engine, have access to personal information, unlock profile, and exit valet mode with an enrolled fingerprint.



### Fingerprint Authentication System Settings

To use the system, the driver's fingerprint should be enrolled in the driver's profile. The driver can set or delete their fingerprint through the infotainment system. Follow the procedures below.

#### Important Information

- Touch the fingerprint authentication sensor gently. Fingerprint authentication attempts with excessive force may fail.
- If no fingerprint is enrolled in the infotainment system, the sensor will not operate.
- A maximum of two fingerprints can be enrolled. Driver 1 and Driver 2 can enroll one fingerprint each.
- To register your fingerprint, you must have both smart keys with you (if equipped with engine start-up feature with fingerprint authentication).
- Please remove all substances, including protective film on the fingerprint sensor, and enroll your fingerprint.
- The fingerprint enrollment process is canceled when the following conditions occur:
  - The infotainment system screen is altered.
  - The Engine Start/Stop button turns on or off.
  - The gear is shifted and the vehicle is driven.

# CONVENIENCE SETTINGS/FEATURES

## Enrolling Fingerprint

1. Turn on the vehicle with a smart key.
2. Select 'Setup → User Profile Settings → Fingerprint Identification' on the infotainment system screen.
3. Set password to access the Fingerprint Identification menu.
4. Once a password is set up, select 'Add/Delete Fingerprint.'
5. Following the instructions, place several parts of your fingerprint until the scanning process is complete.
6. Once the scanning process is completed, the message 'Saving fingerprint...' appears and the fingerprint enrollment process is complete.
7. When the fingerprint enrollment process is completed in the vehicle, the status is displayed on the infotainment system.

## Deleting Fingerprint

1. Select 'Setup → User Profile Settings → Driver 1 → Fingerprint Identification → Set/Delete Fingerprint → Delete' in the infotainment system.
2. Delete the enrolled fingerprint according to the message 'Delete all Driver 1 fingerprints?'
3. Once the fingerprint is deleted, the status is displayed on the infotainment system screen.

### Important Information

To delete your fingerprint, at least one smart key must be in the vehicle (if equipped with engine start-up feature with fingerprint authentication).

### CAUTION

Do not participate in duplicating your fingerprint with anyone.

# CONVENIENCE SETTINGS/FEATURES

## FINGERPRINT AUTHENTICATION SYSTEM OPERATION

### Using Features with Touch Control

The convenient features such as personal information access, profile unlock, and valet mode exit are available with the fingerprint authentication system. When the fingerprint shape appears on the infotainment system screen, place your finger on the recognition sensor in the vehicle according to the instruction message for authorization. You can then operate the linked features without entering the password.

If the fingerprint authentication system does not work, pull your finger away from the fingerprint authentication sensor and then try again. Fingerprint-linked features can be turned on or off from the Settings menu. Select:

- Setup → User Profile Settings → Driver 1 (or Driver 2) → Fingerprint Identification

### Important Information

You cannot link a profile with the same fingerprint for Driver 1 and Driver 2. The personalization function works with the recently linked profile, and the previously linked profile will be automatically canceled.

# CONVENIENCE SETTINGS/FEATURES



## EV Settings

The check battery function can measure energy consumption. In addition, you can set limits on AC/DC maximum charge, AC charging current, smart regeneration, lock charging cable, and charging voice prompts.

## Charging Status Electric Charging door

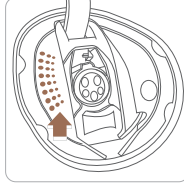

Lamp status	Battery SOC (%)	Lamp status	Battery SOC (%)
	0~12.5		50~62.5
	12.5~25		62.5~75
	25~37.5		75~87.5
	37.5~50		87.5~100

SOC: State of Charge

## EV CHARGING BASICS

GV60 EV [JW] [Battery Capacity = 77.4 kWh]					
Charge Speed	Plug Type	Charger Description	Amb Temp	Est. Charge Time	Comments
Level 1		Portable charger Portable charger provided with vehicle	room temp 68-72F	55hrs	from 10-80% SOC
				66hrs	
				81hrs	
				108hrs	
Level 2		Household EV charger Public Charger	room temp 68-72F	32hrs	from 10% to 80% SOC
				68hrs	from 10% to 100% SOC
Level 3		DCFC	room temp 68-72F	10-20hrs	from 10% to 80% SOC
				7hrs 42min	from 10% to 80% SOC
Level 3		DCFC	room temp 68-72F	18min	from 10% to 80% SOC
				1hr 13min	from 10% to 80% SOC

Depending on the condition and durability of the high-voltage battery, charger specifications, and ambient temperature, the time required for charging the high-voltage battery may vary.

# CONTROL KNOB

## NAME AND FUNCTION OF EACH COMPONENT

### FRONT SEAT CONTROL KEYS

The image of this product may be different from the actual product.

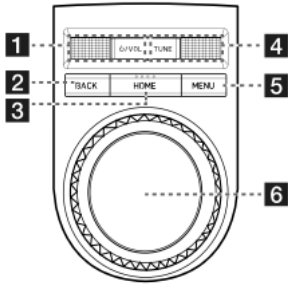

#### 1 $\phi$ /VOL wheel button

- Press briefly to turn AV on/off.
- Press and hold to turn on or off the display and AV.
- Turn the wheel up/down to adjust the volume.

#### 2 BACK button

- Press briefly to move to the previous screen.
- Press and hold to go to the home screen.

#### 3 HOME button

- Press briefly to go to the home screen.
- Press and hold to go to the map screen.

#### 4 TUNE wheel button

- Radio mode: Turning the wheel up/down to increases/decreases the frequency by one step. (FM: 0.2MHz, AM: 10KHz)
- SXM mode: Turning the wheel up/down to increases/decreases the channel by one step.

- USB/Sounds of nature/Voice memo/Bluetooth audio mode: Search for a file by turning the wheel up/down. And, when the name of desired file is displayed, press the button to play the file.
- Rotate the wheel up/down to change the map scale on the map screen.
- Navigation: Turn up/down to change the map scale on the map screen.

#### 5 MENU button

- Displays a pop-up menu for each mode when pressed briefly.
- Turns on and off the split screen on the map when pressed and held.

#### 6 Controller

- Use controller to move and select the menu.
- Rotate the controller to change the map scale on the map screen.

### USING CONTROLLER AND TOUCHPAD

Rotate controller to left/right or use touchpad to switch or select the menu.

Controller	Details
	Rotate controller to left/right to switch the menu.
	Swipe up/down/left/right to switch the menu.
	Press touchpad to select the menu. Write the desired words or gesture on the touchpad.
	Push controller to up/down/left/right/diagonal directions to switch the menu.

### VOLUME CONTROL

#### RADIO/MEDIA VOLUME CONTROL

When radio/media is in play, turn  $\phi$ /VOL the wheel up/down on the front seat control key to control the volume.

#### BLUETOOTH AUDIO VOLUME CONTROL

When Bluetooth audio is in play, turn  $\phi$ /VOL the wheel up/down on the front seat control key to control the volume.

#### VOICE RECOGNITION GUIDE VOLUME CONTROL

When voice guidance is in play, turn  $\phi$ /VOL the wheel up/down on the front seat control key to control the volume.

#### BLUETOOTH PHONE VOLUME CONTROL

During Bluetooth phone call, turn  $\phi$ /VOL the wheel up/down on the front seat control key to control the volume.

### TURNING AV OFF

Press  $\phi$ /VOL the wheel on the front seat control key when the AV is ON.

### TURNING AV ON

Press  $\phi$ /VOL the wheel on the front seat control key when the AV is OFF.

### HOME BTN (BY CONTROLLER)

This menu is used to set the function to be activated when the [HOME] button is pressed briefly.

1. On the button/touch pad settings screen, press the [Home Btn (by Controller)].



2. Press the desired item.

### TURNING THE SYSTEM OFF

Press and hold  $\phi$ /VOL the wheel on the front seat control key.

To turn the system on again, press  $\phi$ /VOL the wheel on the front seat control key.

#### NOTE

Check the volume when turning on the system. Before turning on the system, adjust the volume to a reasonable level.